



# MODEL 9594

- There are three ways to install this mounting kit: to a pole, a roof or a wall. Follow the instructions carefully to successfully complete the assembly. You should only use two of the instructional sections:

1. Combo assembly, sections 1, 2 or 3, depending on your combo, i.e., Impact™, Fusion™ or metal-framed backboard
2. 9594 kit assembly and installation, sections 4, 5 or 6, depending on your installation type, i.e., to a pole, a roof or a wall

The **Parts Identifier**, located at the center of this manual, consists of four yellow pages displaying all the parts and hardware included with both the 9594 kit and the purchased backboard & rim combo. It can be removed from these instructions and used as a quick reference throughout the assembly and installation. Use the **Parts Identifier** to verify that all parts and hardware are included and in working order.

- 
- The image contains three separate line drawings, each illustrating a different method for mounting a solar panel system. Each drawing shows a central vertical support structure with two angled arms extending upwards, presumably to hold solar panels. The 'Pole Mount' drawing shows the structure attached to a single vertical pole. The 'Roof Mount' drawing shows the structure attached to a horizontal surface, likely a roof, with mounting brackets. The 'Wall Mount' drawing shows the structure attached to a vertical wall, with mounting brackets and a horizontal support arm.
- Pole Mount*
- Roof Mount*
- Wall Mount*

7/16" ( $\approx 11$  mm) (x2)

1/2" ( $\approx 13$  mm) (x1)

9/16" ( $\approx 14$  mm) (x2)

3/4" ( $\approx 19$  mm) (x2)

3/8" ( $\approx 10$  mm) (x1)

1/2" ( $\approx 13$  mm) (x1)

(x3)

(x1)

(x1)

(x1)

(x3)

(x1)

Icon Legend.....	2
Warnings & Notices.....	3
What to Expect.....	4
Impact™ Backboard & Rim Assembly.....	5
Fusion™ Backboard & Rim Assembly.....	12
Steel-Framed Backboard & Rim Assembly.....	20
<b>Parts Identifier.....</b>	<b>i–iv</b>
Pole-Mount Assembly.....	33
Roof-Mount Assembly.....	38
Wall-Mount Assembly.....	43
Registration.....	50
Warranty.....	51

Model Number: 9594  
Product ID:



## ICON LEGEND



- Indicates special heed should be taken when reading.



- Indicates the parts to be used for a section.



- Indicates no parts required for a specific section.



- Indicates the hardware to be used for a section.



- Indicates no hardware required for a specific page.



- Indicates the tools to be used for a section.



- Indicates to use an electric drill for a specific step.



- Indicates not to use an electric drill for a specific step.



- These nuts are centerlock nuts. They are designed to be tight; therefore, they will be harder to tighten. Tighten until flush with the metal or plastic.



- Indicates the number of adults required for a specific step, i.e., 2, 3, 4, etc.



## WARNINGS & NOTICES



### SAFETY INSTRUCTIONS



**FAILURE TO FOLLOW THESE WARNINGS MAY RESULT IN SERIOUS INJURY OR PROPERTY DAMAGE AND WILL VOID WARRANTY.**

***Owner must ensure that all players know and follow these rules for safe operation of the system.***

To ensure safety, do not attempt to assemble this product without following the instructions carefully. Check entire box and inside all packing material for parts and/or additional instruction material. Before beginning assembly, read the instructions and identify parts using the hardware identifier and parts list in this document. Proper and complete assembly, use and supervision are essential for proper operation and to reduce the risk of accident or injury. A high probability of serious injury exists if this product is not installed, maintained, and operated properly.

- If using ladders during assembly, use extreme caution.
- Three capable adults are recommended for this operation.
- Minimum operational height is 6 ft 6 in (1.98m) to the bottom of the backboard.

***Most injuries are caused by misuse and/or not following instructions. Use caution when using this product.***



## WHAT TO EXPECT

This set of instructions explains not only how to assemble and mount the 9594 kit to a pole, roof or wall but also explains how to assemble and mount Lifetime's backboard & rim combo models that can go with it. Lifetime has many models but only three types of backboards:

1. **Impact™**—Lifetime has one type of supported, blow-molded, Impact™ backboard. The supported Lifetime® models are 3823 and 90703. The backboard will look like the one below:

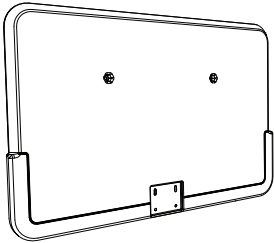

2. **Fusion™**—Lifetime has two types of blow-molded, Fusion™ backboards: rectangular with squared corners and rectangular with rounded corners. They look slightly different (only at the corners) but assemble the same way. The supported Lifetime® models are 90086, 73621 and 73650. Your backboard will look like one of the two below:

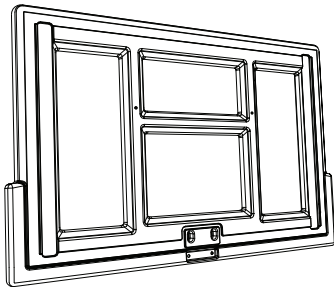

*OR*

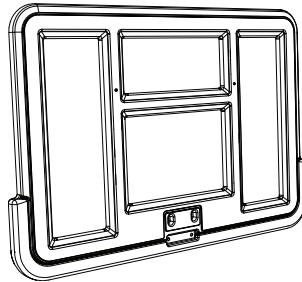

*Fusion™: Squared corners (Rear view)*

*Fusion™: Rounded corners (Rear view)*

3. **Metal-framed**—all of Lifetime's metal-framed backboards assemble in a similar way. The only differences are the sizes, e.g., 50", 52", 54", etc., and that one comes with pre-assembled corner guards and the others come with frame pads to be assembled by the customer. The supported Lifetime® models are 71526, 73729, 79910, 90010, 90087 and 90718. The backboards will look similar to the one below:

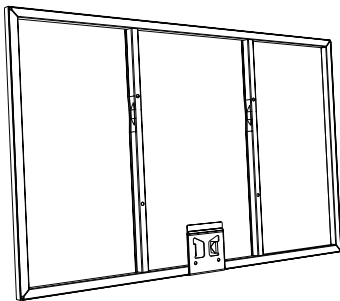

Besides the required tools shown on the cover page, the following are needed:

1. This set of instructions
2. Lifetime® Kit 9594 (including its hardware)
3. The purchased Lifetime® backboard & rim combo (including its hardware)
4. If necessary, the appropriate hardware for mounting the kit to a roof or wall (can be obtained at a local hardware store)

**What you won't need:**

1. The instructions that came with the Lifetime® backboard & rim combo. It's necessary, however, to keep them for future reference. They contain important information in case Customer Service must be contacted for replacement parts.

**Now, let's get started.**

**For an Impact™ backboard, start with section 1.**

**For a Fusion™ backboard, start with section 2.**

**For a metal-framed backboard, start with section 3.**



# 1

## IMPACT™ BACKBOARD & RIM ASSEMBLY



### HARDWARE REQUIRED

**9594 HARDWARE: ONLY THE HARDWARE USED IN THIS SECTION IS SHOWN HERE.**

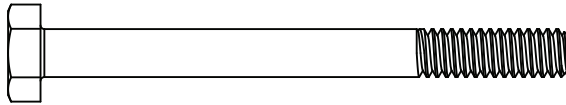

AAS (x2)



ABS (x2)



AAB (x2)

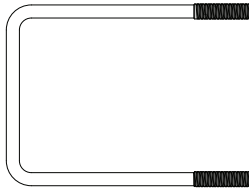

BNP (x1)



DZS (x2)

- Needed only for a roof installation

- Unless instructed otherwise, use the U-bolt that came with your purchased backboard and rim combo.  
For model 90718 only: use the U-bolt that came with this 9594 mounting kit.

## HARDWARE BAG FOR IMPACT™ MODELS 3823 AND 90703

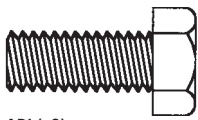

APJ (x2)

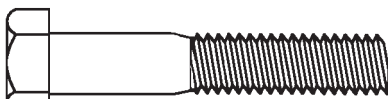

AAC (x2)



APN (x4)

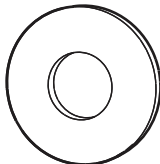

ABD (x4)

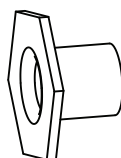

AAJ (x2)

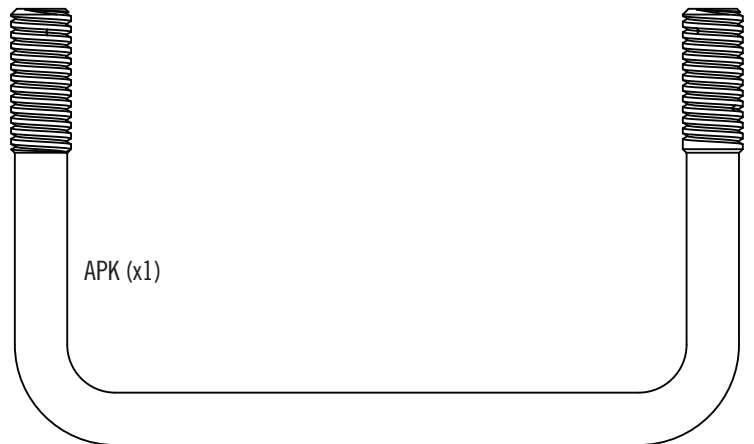

APK (x1)

# 1

## IMPACT™ BACKBOARD & RIM ASSEMBLY



### PARTS REQUIRED

#### 9594 KIT PARTS:

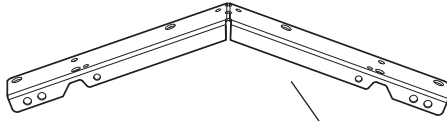

ESF (x2)

More parts come with the 9594 kit, but only the parts used in this section are shown here.

#### COMBO KIT PARTS:

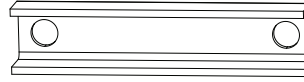

AOX (x1)

### COMBO KIT IMPACT™ BACKBOARD FROM MODELS 3823 AND 90703

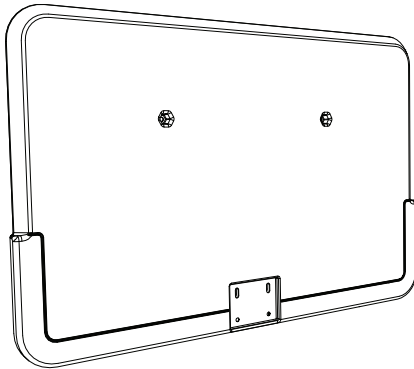

AJI (x1)



### TOOLS REQUIRED



7/16" (≈11 mm)  
(x2)



1/2" (≈13 mm)  
(x1)



(x2)

## ► SECTION 1 (CONTINUED)

### TOOLS AND HARDWARE REQUIRED

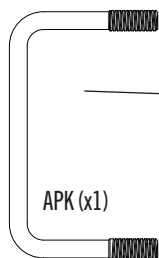

- Use the U-bolt included with your purchased backboard and rim combo.

## 1.1

- **IMPORTANT: USE THE U-BOLT THAT CAME WITH YOUR PURCHASED BACKBOARD AND RIM COMBO.**

Using the U-bolt that came with your backboard & rim combo, insert the **U-bolt (APK)** through the holes in the **backboard brackets (ESF)** as indicated.

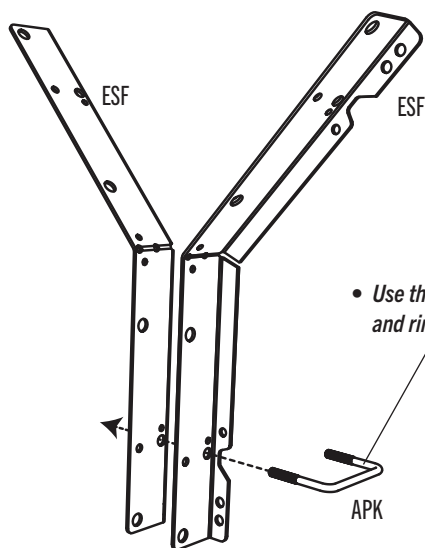

## 1.2

- Rotate the U-bolt as shown. It should rest in the notches.

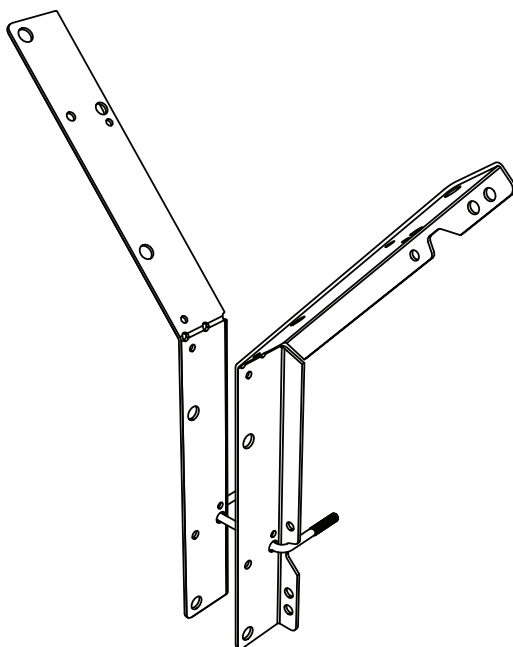

## ► SECTION 1 (CONTINUED)

### TOOLS AND HARDWARE REQUIRED



7/16" (≈11 mm)  
(x2)



(x1)

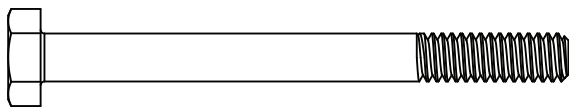

AAS (x2)

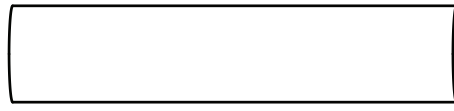

ABS (x2)

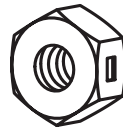

AAB (x2)

## 1.3

- Position the **spacers (ABS)** between the backboard brackets, ensuring they are aligned with the correct holes in the brackets. Slide a **hex bolt (AAS)** through the brackets and each spacer, and secure them with **centerlock nuts (AAB)**. **Now let's attach these backboard brackets to the backboard and rim combo.**

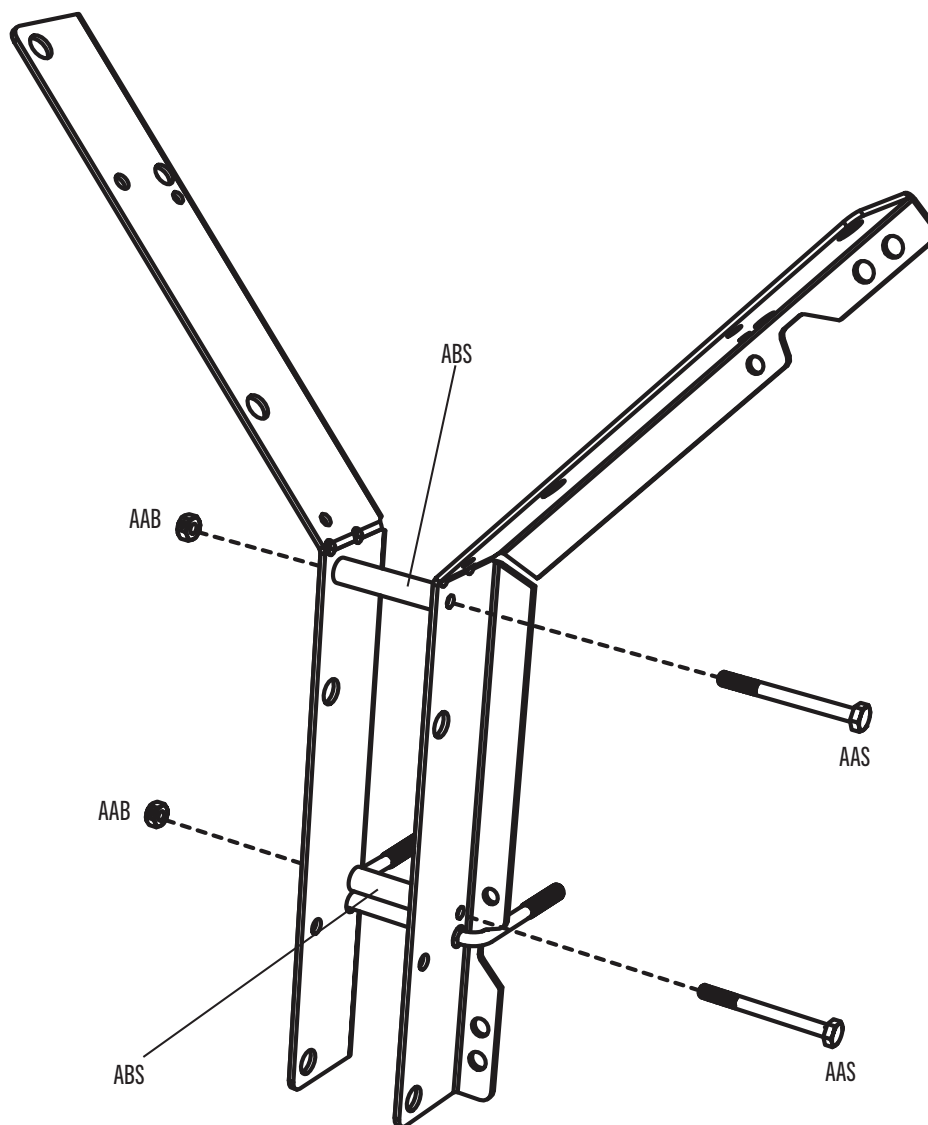

- These nuts are centerlock nuts. They are designed to be tight; therefore, they will be harder to tighten. Tighten until the spacers are flush with the backboard brackets.*

## ► SECTION 1 (CONTINUED)

### TOOLS AND HARDWARE REQUIRED



1/2" (≈13 mm)  
(x1)



(x2)

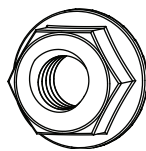

APN (x2)

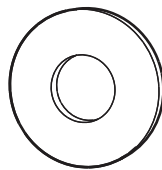

ABD (x2)

# 1.4

## IMPACT™ BACKBOARD-TO-RIM-AND-BACKBOARD-BRACKETS ASSEMBLY

- Set the backboard brackets from steps 1.1–1.2 onto the back of the **Impact™ backboard (AJI)** with the U-bolt through the backboard as shown. Secure the U-bolt with the hardware indicated.

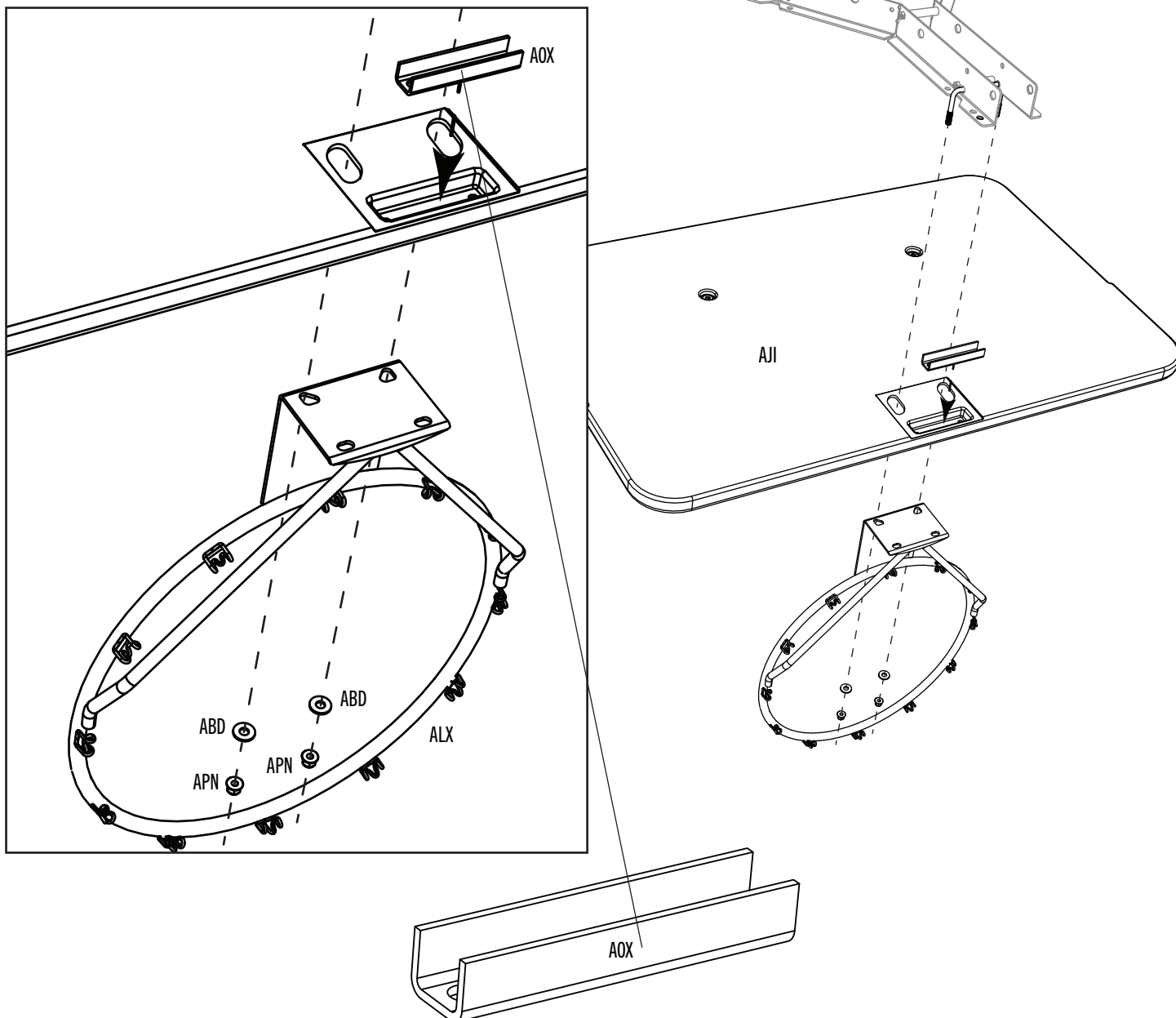

## ► SECTION 1 (CONTINUED)

### TOOLS AND HARDWARE REQUIRED



1/2" (≈13 mm)  
(x2)



(x2)

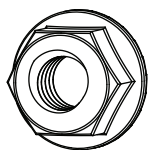

APN (x2)

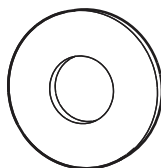

ABD (x2)

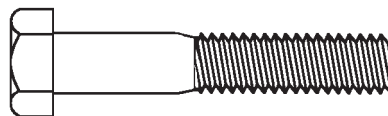

AAC (x2)

# 1.5

- Now, secure the backboard brackets to the backboard using the hardware indicated. **Ensure the support channel (AOX) was inserted into the slot in the backboard in step 1.4.**

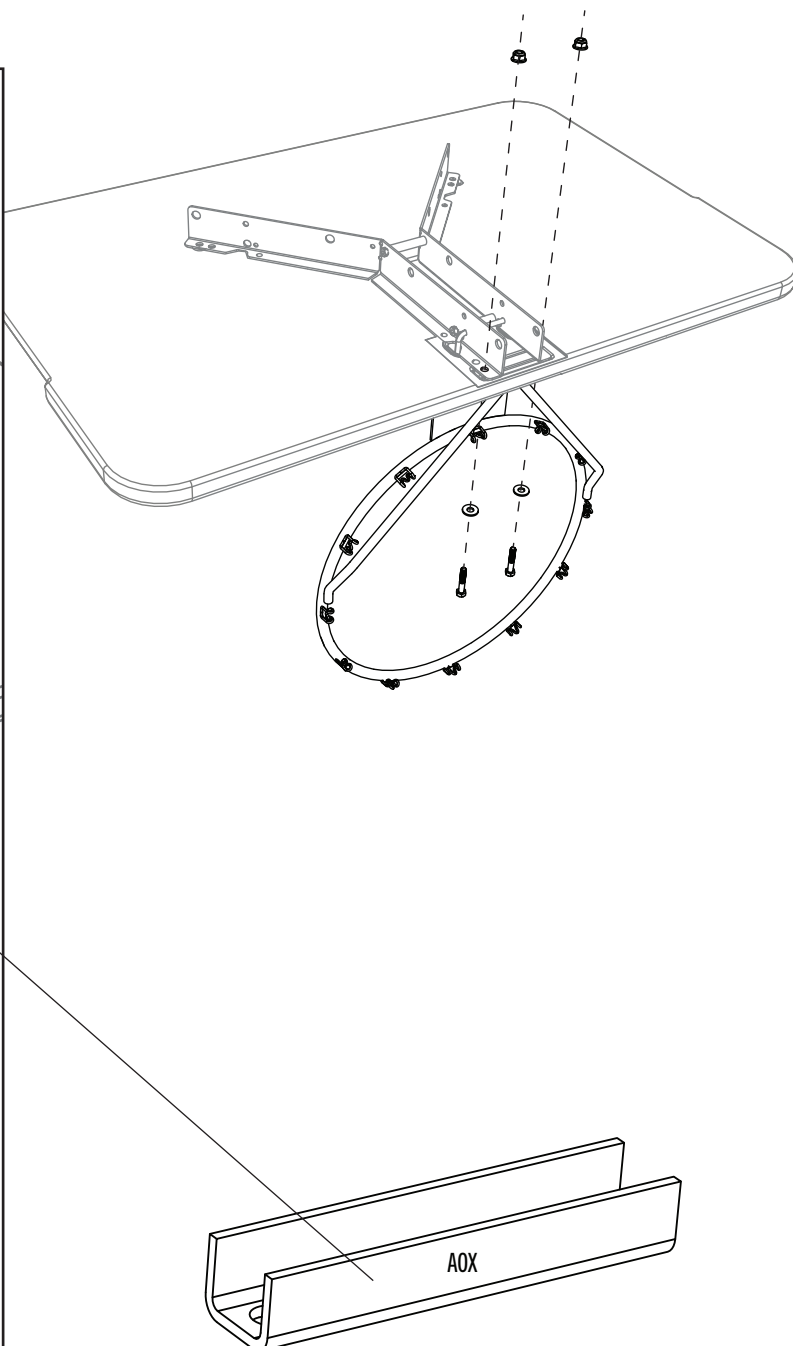
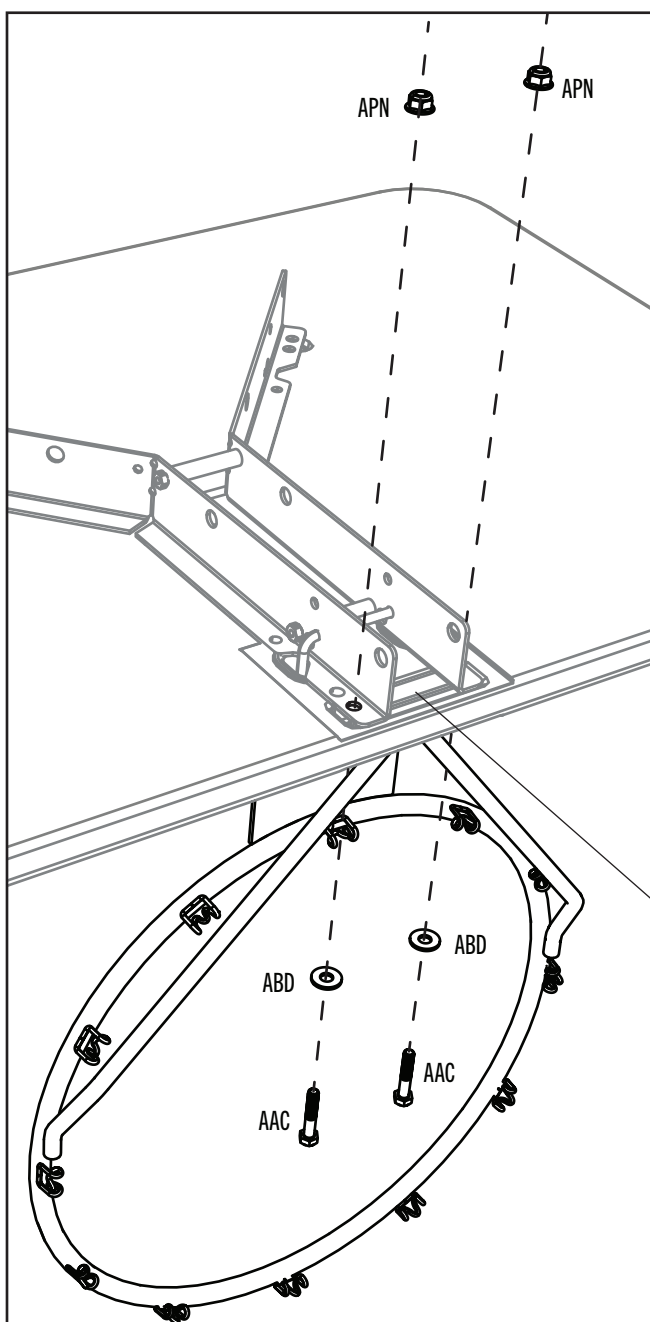

## ► SECTION 1 (CONTINUED)

### TOOLS AND HARDWARE REQUIRED



1/2" (≈13 mm)  
(x1)



(x2)

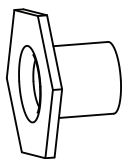

AAJ (x2)

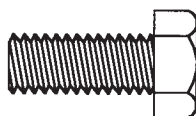

APJ (x2)



DZS (x2)

• Needed only for a roof installation

### 1.6a



- If you are installing kit 9594 to a roof, follow this step (1.6a):

- Attach backboard brackets and angle braces (DZS) to the backboard using the hardware indicated. Leave both braces loose until instructed. Set the assembly aside.

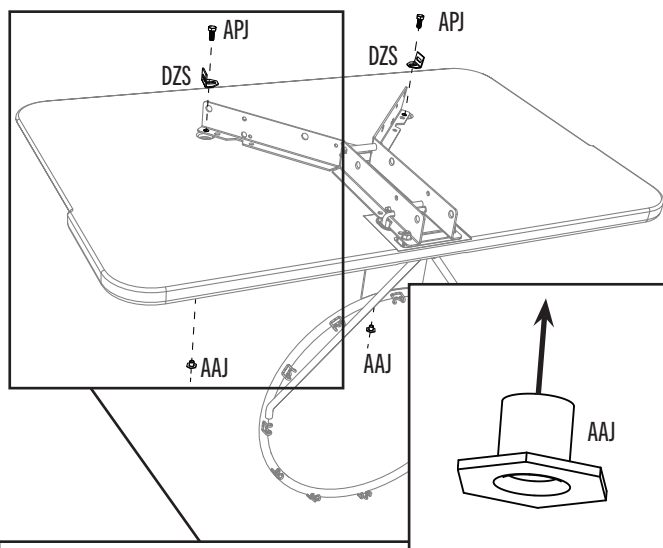

### 1.6b



- If you are installing kit 9594 to a pole or wall, follow this step (1.6b):

- Secure the backboard brackets to the backboard using the hardware indicated. Set the assembly aside.

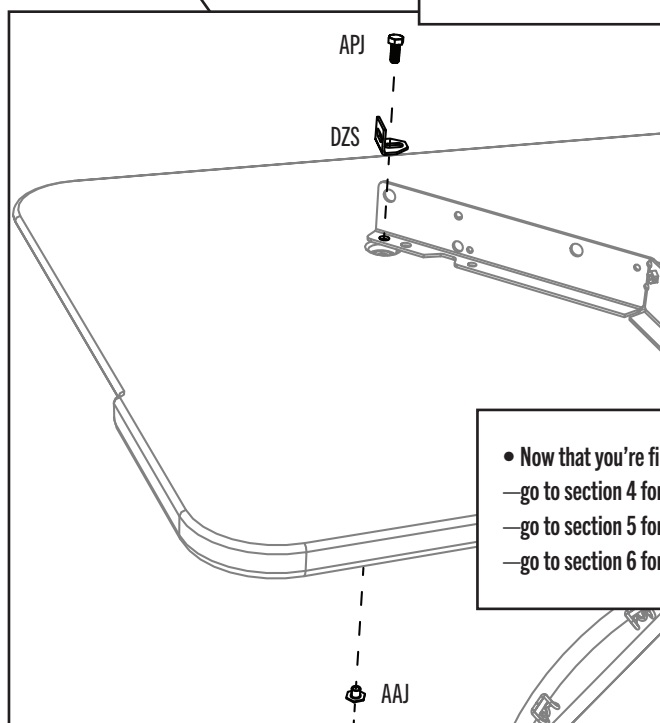
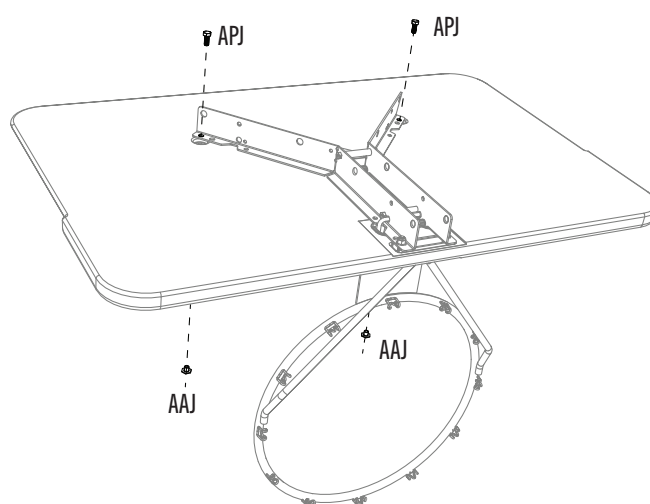

- Now that you're finished assembling the combo,
  - go to section 4 for mounting the kit and combo to a pole.
  - go to section 5 for mounting the kit and combo to a roof.
  - go to section 6 for mounting the kit and combo to a wall.



## HARDWARE REQUIRED

**9594 HARDWARE: ONLY THE HARDWARE USED IN THIS SECTION IS SHOWN HERE.**

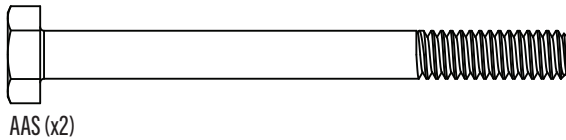

AAS (x2)

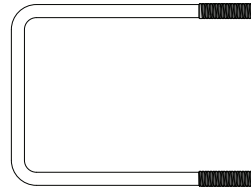

BNP (x1)



DZS (x2)

- Needed only for a roof installation



AAB (x2)



ABS (x2)

- Unless instructed otherwise, use the U-bolt that came with your purchased backboard and rim combo. For model 90718 only: use the U-bolt that came with this 9594 mounting kit.

**HARDWARE BAG FOR FUSION™ MODELS 90086, 73621 AND 73650**



ABK (x4)

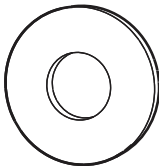

ABD (x2)

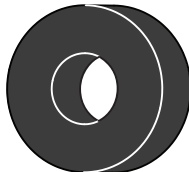

ABF (x2)

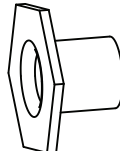

AAJ (x2)

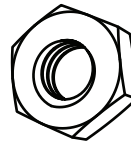

AAV (x2)



AJW (x2)

\* Not to scale

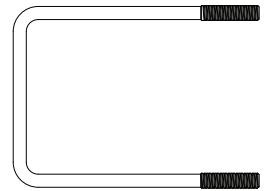

BNP (x1)

- Unless instructed otherwise, use the U-bolt that came with your purchased backboard and rim combo. For model 90718 only: use the U-bolt that came with this 9594 mounting kit.

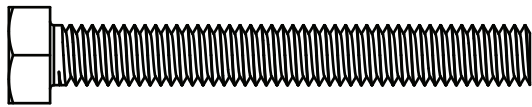

ABG (x2)

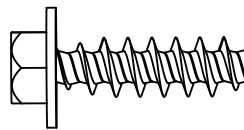

ADQ (x2)



AOW (x1)

\* Not to scale



## PARTS REQUIRED

**9594 PARTS:**

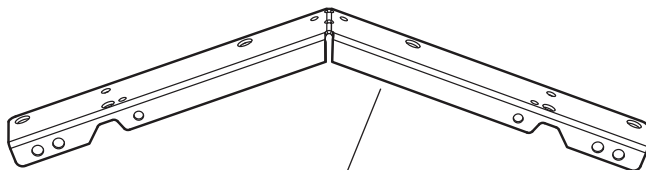

ESF (x2)

More parts come with the 9594 kit, but only the parts used in this section are shown here.

**COMBO KIT PARTS:**

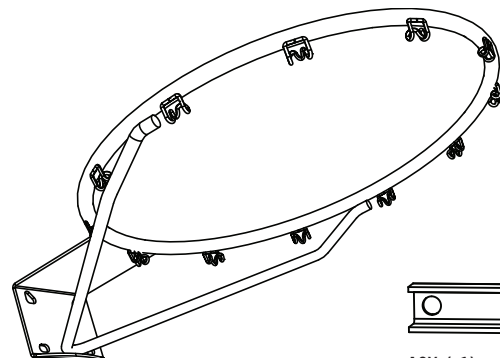

ALX (x1)

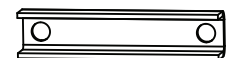

AOX (x1)



# 2

## FUSION™ BACKBOARD & RIM ASSEMBLY



### PARTS REQUIRED

*COMBO KIT FUSION™ BACKBOARDS FROM MODELS 90086, 73650 AND 73621*

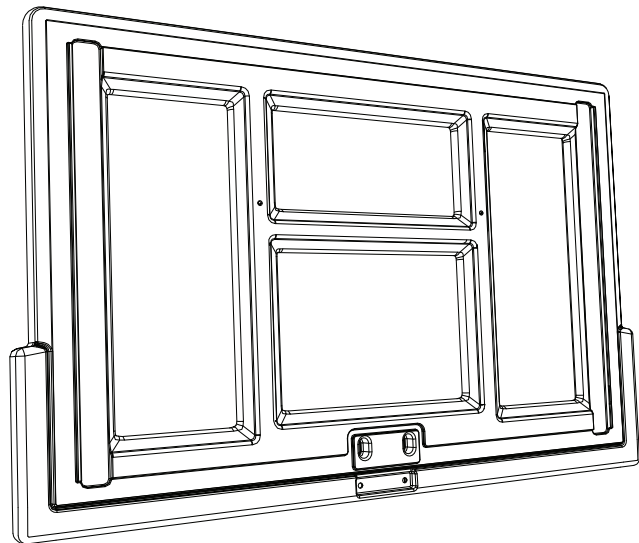

AJI (x1)

*OR*

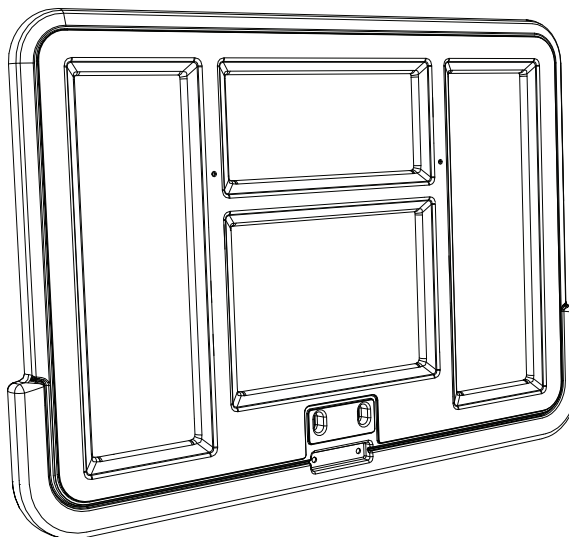

AJI (x1)



### TOOLS REQUIRED



7/16" (≈11 mm)  
(x2)



1/2" (≈13 mm)  
(x1)



3/8" (≈10 mm)  
(x2)



(x1)



(x1)

## ► SECTION 2 (CONTINUED)

### TOOLS AND HARDWARE REQUIRED



(x1)

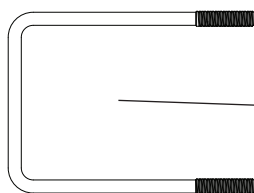

BNP (x1)

- Use the U-bolt that came with your purchased backboard and rim combo.

## 2.1

.....  
**IMPORTANT: USE THE U-BOLT THAT CAME WITH YOUR PURCHASED BACKBOARD AND RIM COMBO.**

- Insert the U-bolt (BNP) through the holes in the backboard brackets (ESF) as indicated.

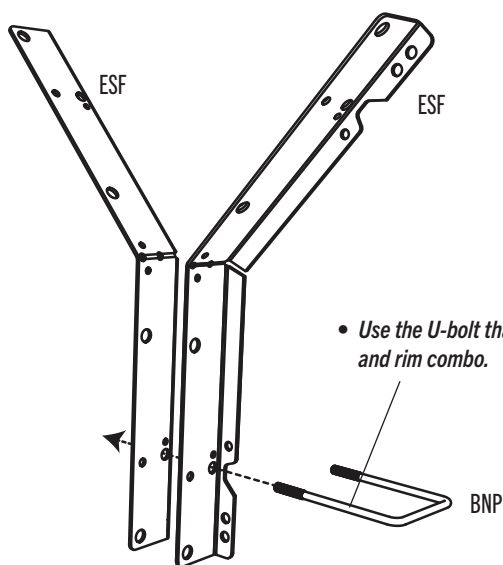

- Use the U-bolt that came with your purchased backboard and rim combo.

## 2.2

- .....
- Rotate the U-bolt as shown. It should rest in the notches.

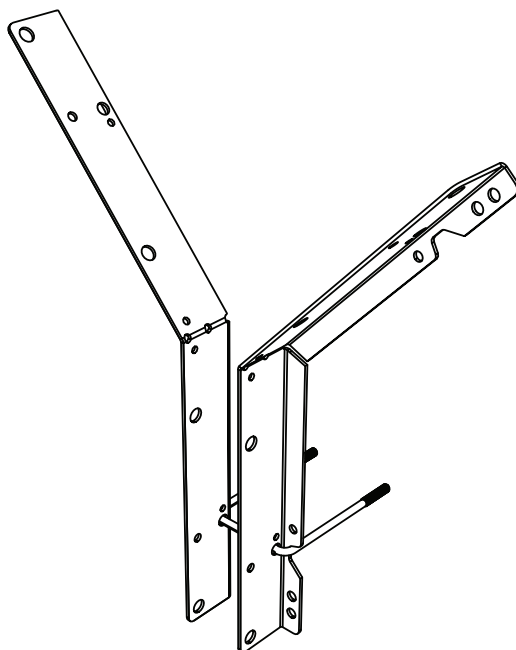

## ► SECTION 2 (CONTINUED)

### TOOLS AND HARDWARE REQUIRED



7/16" (≈11 mm)  
(x2)



(x1)

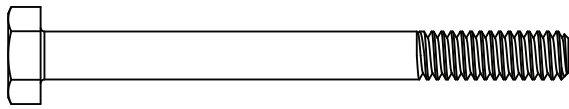

AAS (x2)

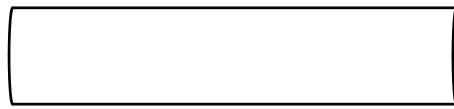

ABS (x2)

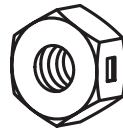

AAB (x2)

## 2.3

- Position the **spacers (ABS)** between the **backboard brackets (ESF)**, ensuring they are aligned with the correct holes in the brackets. Slide a **hex bolt (AAS)** through the brackets and each spacer, and secure them with **centerlock nuts (AAB)**. Now let's attach these backboard brackets to the Lifetime® backboard & rim combo.

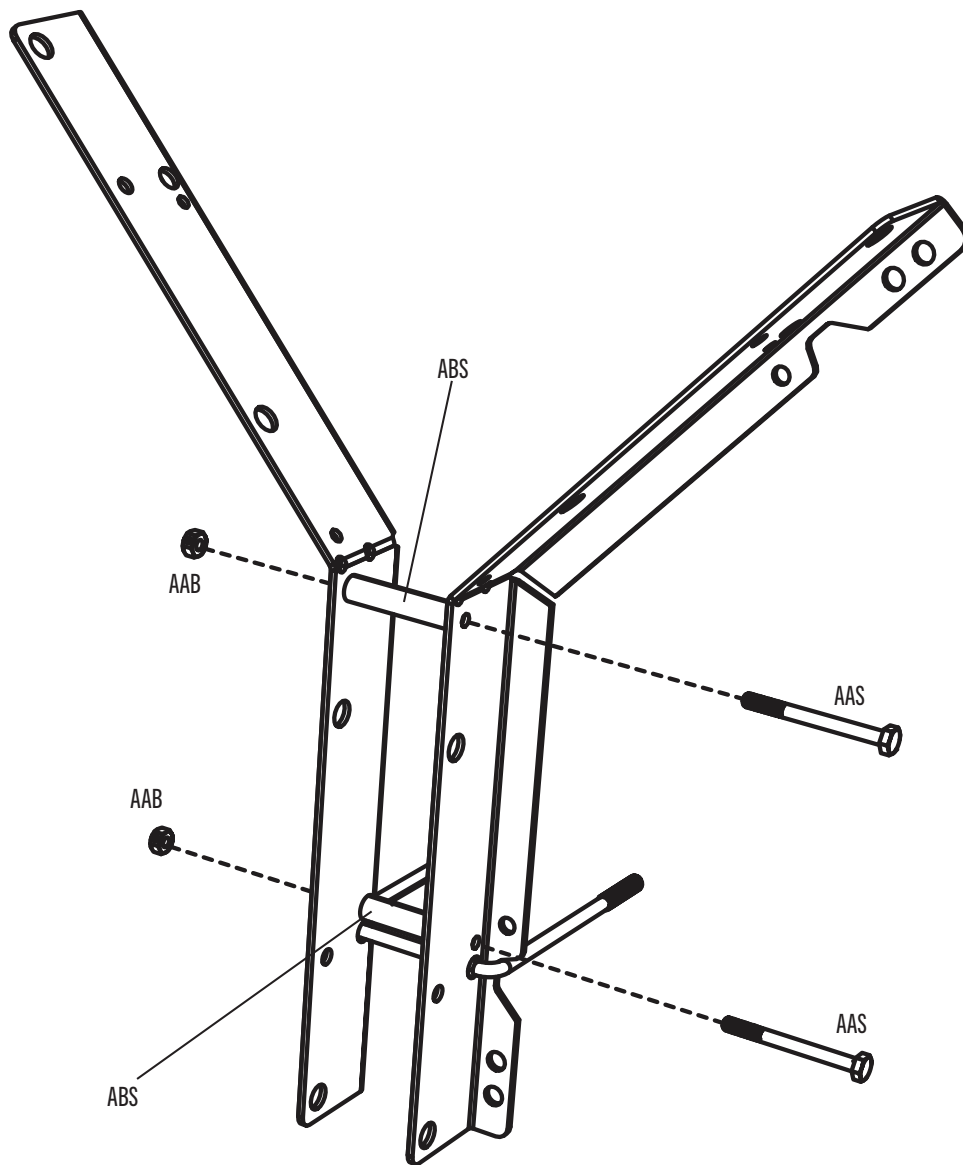

- These nuts are centerlock nuts. They are designed to be tight; therefore, they will be harder to tighten. Tighten until the spacers are flush with the backboard brackets.

## SECTION 2 (CONTINUED)

### TOOLS AND HARDWARE REQUIRED



1/2" (≈13 mm)  
(x1)



(x1)



(x1)

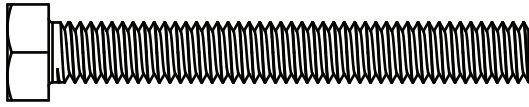

ABG (x2)

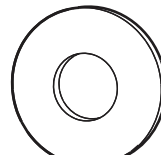

ABD (x2)

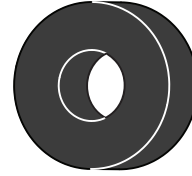

ABF (x2)

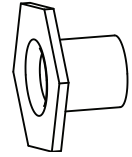

AAJ (x2)



## FUSION™ BACKBOARD-TO-RIM ASSEMBLY

- Lifetime® offers two types of Fusion™ backboards (AJI). They are similar. They just look slightly different. The first has squared corners (Fig. 1), while the second has rounded corners (Fig. 2). Both assemble in the same way. **Only the backboard with squared corners is shown in the assembly in this section.**

*Fusion™ (Squared Corners, Rear View)*

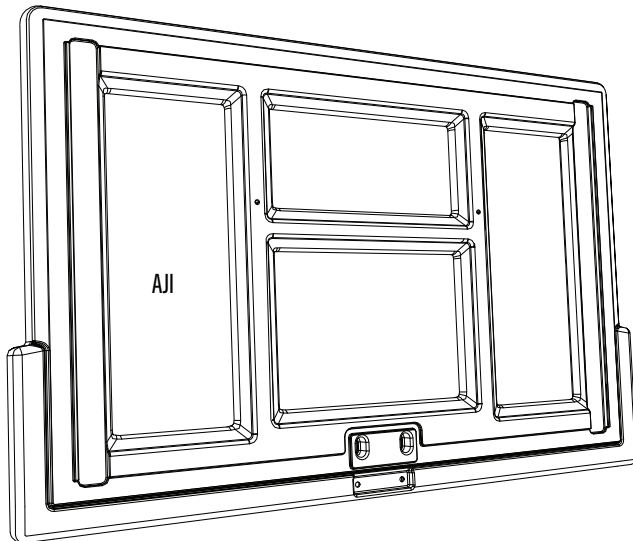

- Some lines have been removed for clarity.

(Fig. 1)

*Fusion™ (Rounded Corners, Rear View)*

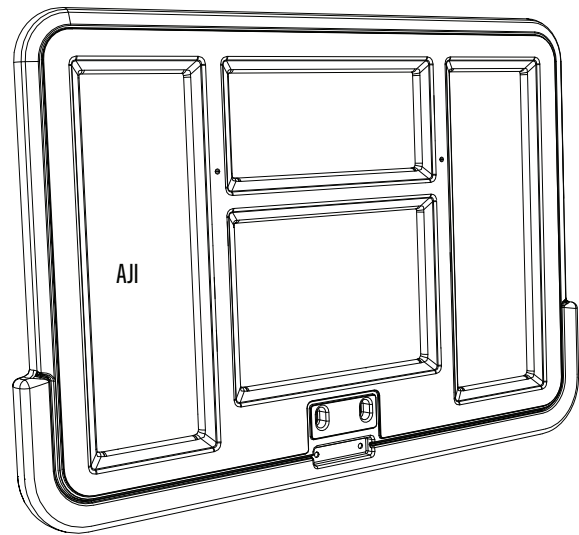

- Some lines have been removed for clarity.

(Fig. 2)

## 2.4

In the next few steps, we'll assemble the Fusion™ backboard and Slam-It™ rim combo to the backboard brackets assembled in steps 2.1–2.3.

- Insert a bolt (ABG) through a washer (ABD), a rubber washer (ABF) and through the hole in the rim (ALX) as indicated. Repeat for the other bolt as indicated. Secure with two T-nuts (AAJ).

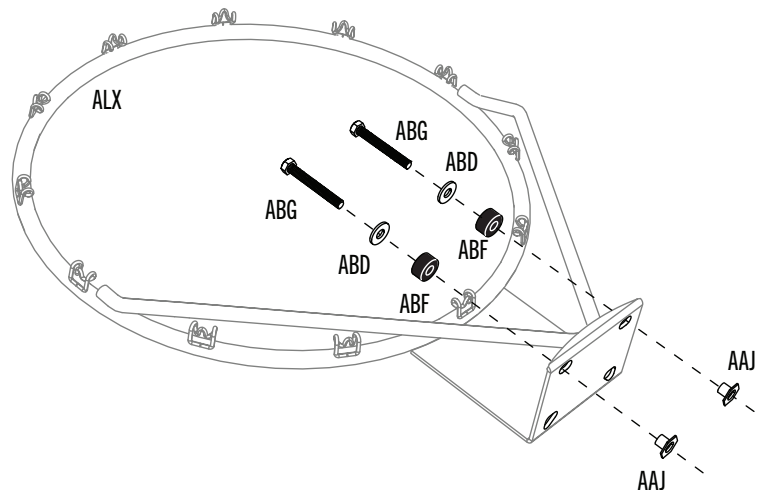

## ► SECTION 2 (CONTINUED)

### TOOLS AND HARDWARE REQUIRED



1/2" (≈13 mm)  
(x1)



(x2)



ABK (x2)

# 2.5



- Lay the backboard face down over a table or box. Insert the U-bolt on the backboard brackets down through the two upper holes in the backboard and rim while inserting the two bolts on the rim up through the two lower holes in the backboard, the **rim support channel (AOX)** and the backboard brackets as shown. Secure the two bolts with **nuts (ABK)**.

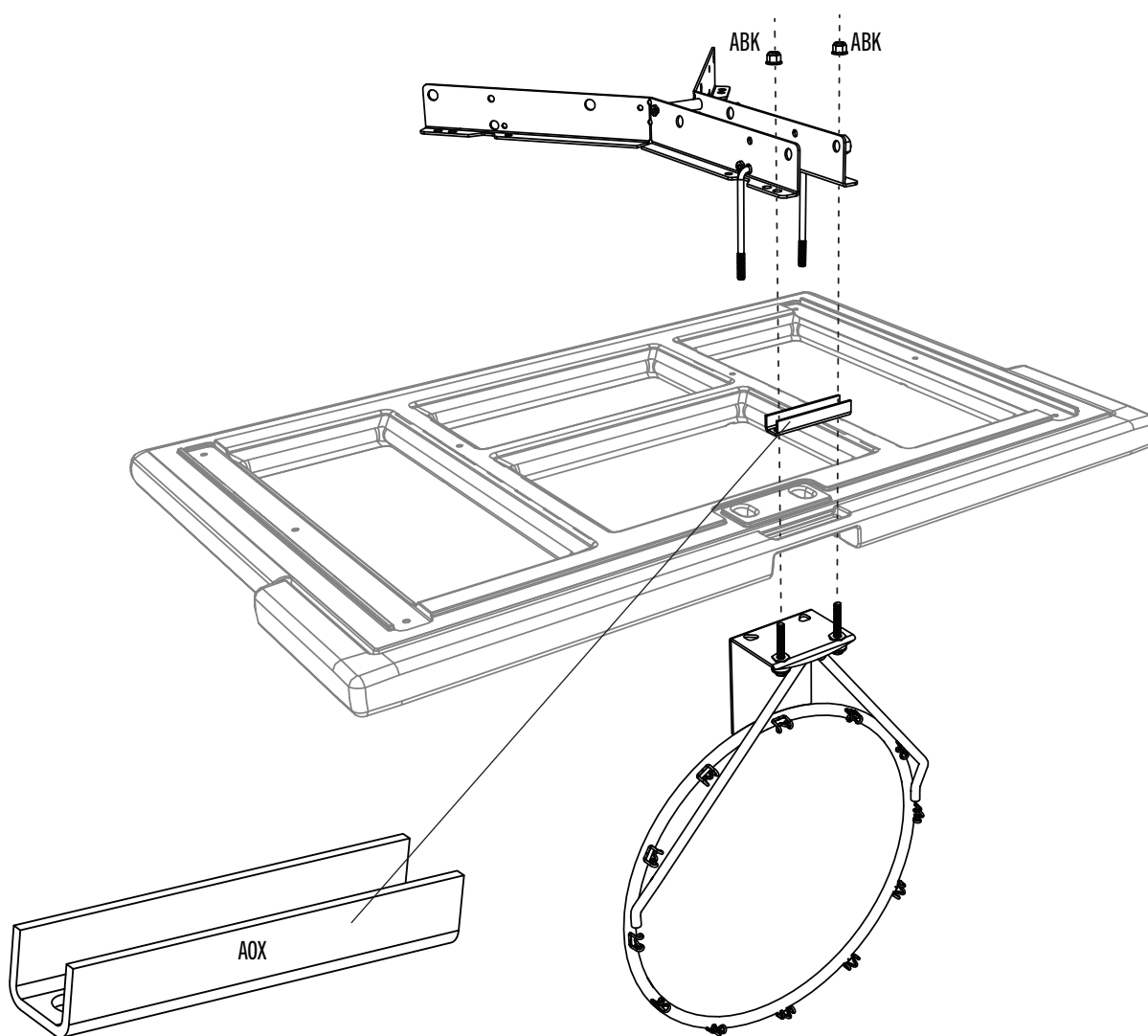

## SECTION 2 (CONTINUED)

### TOOLS AND HARDWARE REQUIRED



1/2" (≈13 mm)  
(x1)



3/8" (≈10 mm)  
(x1)



(x2)

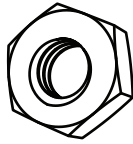

AAV (x2)



ABK (x2)



AOW (x1)

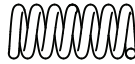

AJW (x2)

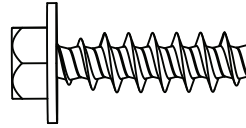

ADQ (x2)



DZS (x2)

• Needed only for a roof installation

# 2.6

- Thread a **jam nut (AAV)** onto each end of the U-bolt as far as they will go. Place the **springs (AJW)** over the two ends of the U-bolt and the **spring retainer plate (AOW)** over the two springs. Secure with **nuts (ABK)**.

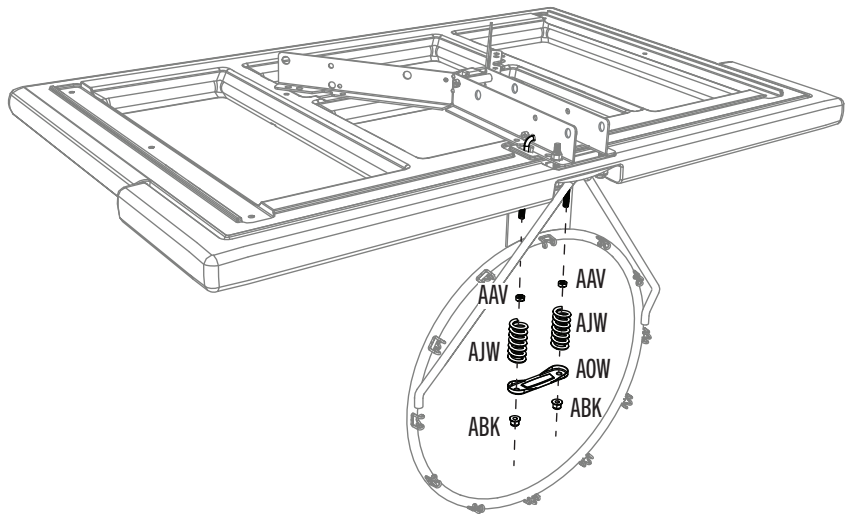

# 2.7a

- If you are installing kit 9594 to a roof, follow this step (2.7a). If not, go to step 2.7b.
- Attach backboard brackets and angle braces (DZS) to the backboard using screws (ADQ). Leave both braces loose until instructed. Set the assembly aside.

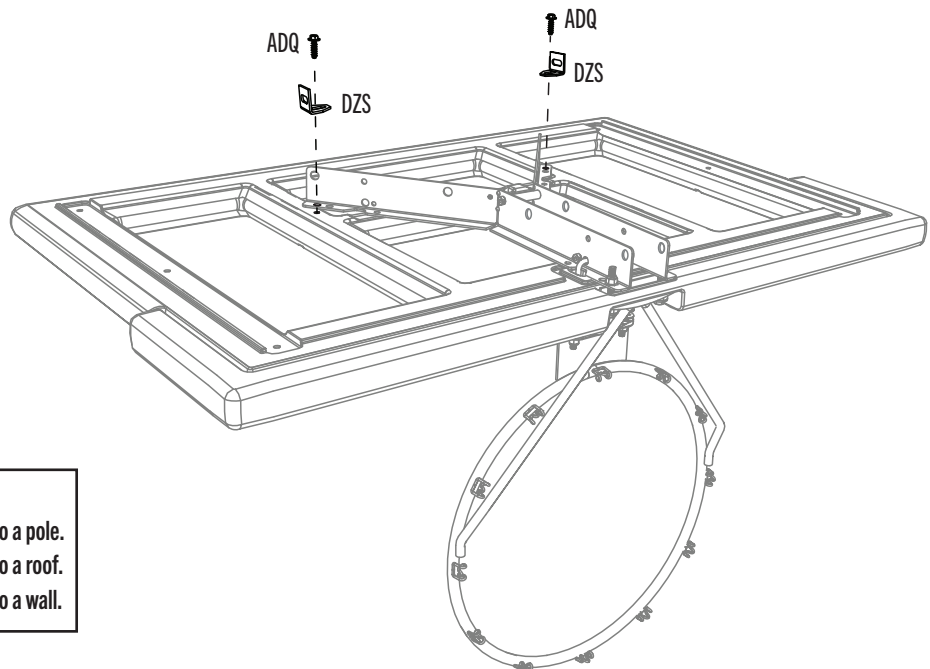

- Now that you're finished assembling the combo,
  - go to section 4 for mounting the kit and combo to a pole.
  - go to section 5 for mounting the kit and combo to a roof.
  - go to section 6 for mounting the kit and combo to a wall.

## ► SECTION 2 (CONTINUED)

### TOOLS AND HARDWARE REQUIRED



3/8"  
(≈10 mm)  
(x1)



(x2)

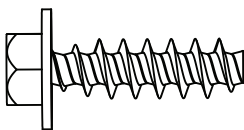

ADQ (x2)

# 2.7b



- If you are installing kit 9594 to a pole or wall, follow this step (2.7b). If not, go back to step 2.7a.
- Align the holes in the ends of the backboard brackets with those in the backboard and secure the brackets to the backboard using two screws (ADQ). Set the assembly aside.

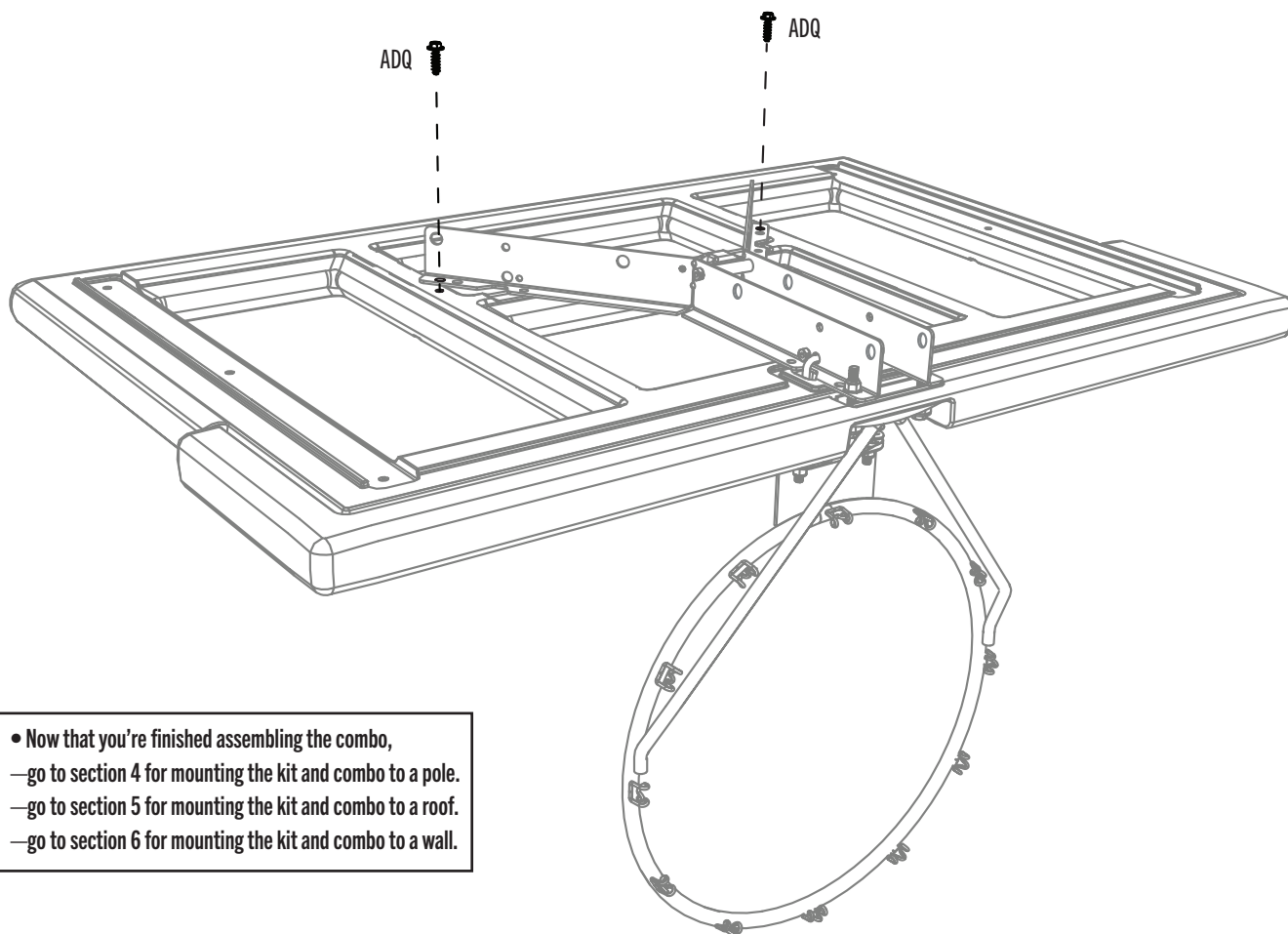

- Now that you're finished assembling the combo,
  - go to section 4 for mounting the kit and combo to a pole.
  - go to section 5 for mounting the kit and combo to a roof.
  - go to section 6 for mounting the kit and combo to a wall.



## 9594 MOUNTING KIT HARDWARE REQUIRED

**9594 HARDWARE: ONLY THE HARDWARE USED IN THIS SECTION IS SHOWN HERE.**

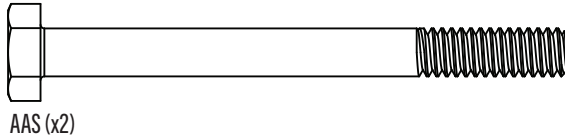

AAS (x2)



ABS (x2)



DZS (x2)

- Needed only need for a roof installation

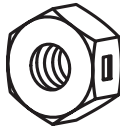

AAB (x2)

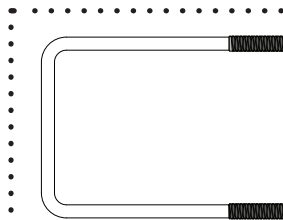

BNP (x1)

25% of actual size

- Unless instructed otherwise, use the U-bolt that came with your purchased backboard and rim combo. For model 90718 only: use the U-bolt that came with this 9594 mounting kit.



## BACKBOARD &amp; RIM COMBO HARDWARE REQUIRED

**HARDWARE BAG FOR METAL-FRAMED MODELS 79910, 73729 AND 71526**

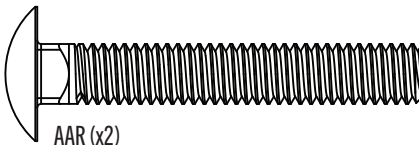

AAR (x2)

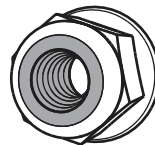

ABK (x6)

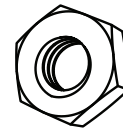

AAV (x2)

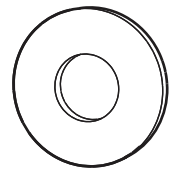

ABD (x2)

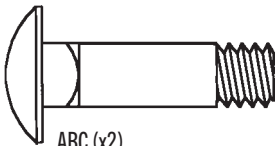

ABC (x2)



ACS (x2)

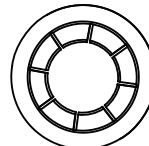

AAQ (x2)

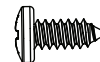

ADR (x4)

Hardware Bag

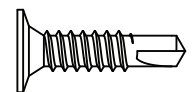

ADP (x10)

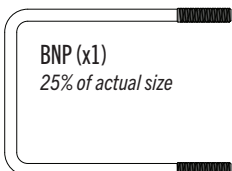

BNP (x1)

25% of actual size



AJW (x2)

25% of actual size

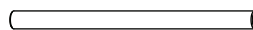

ABQ (x1)

25% of actual size



AOW (x1)

25% of actual size





## BACKBOARD &amp; RIM COMBO HARDWARE REQUIRED

## HARDWARE BAG FOR METAL-FRAMED MODELS 90087 AND 90010

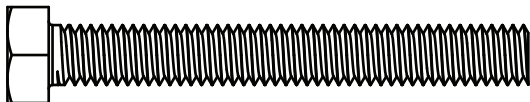
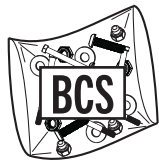

ABG (x2)

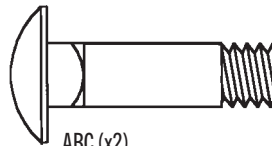

ABC (x2)



ACS (x2)

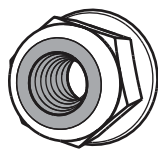

ABK (x6)\*

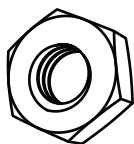

AAV (x2)

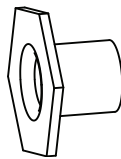

AAJ (x2)

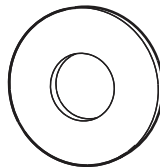

ABD (x2)

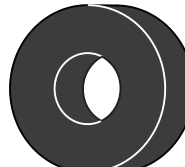

ABF (x2)



\* Hardware Bag BCS contains hardware that may not be used.



AOW (x1)  
25% of actual size



AJW (x2)  
25% of actual size

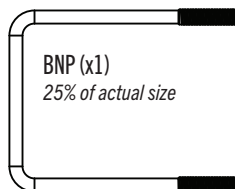

BNP (x1)  
25% of actual size

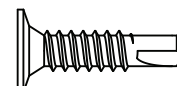

ADP (x10)



## BACKBOARD &amp; RIM COMBO HARDWARE REQUIRED

## HARDWARE BAG FOR METAL-FRAMED MODEL 90718

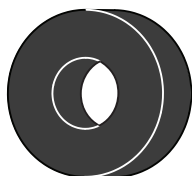
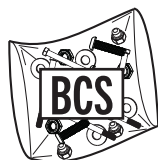

ABF (x2)

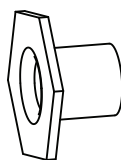

AAJ (x2)

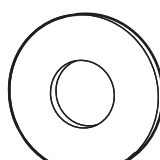

ABD (x2)

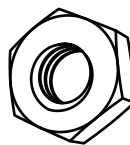

AAV (x2)



ABK (x6)

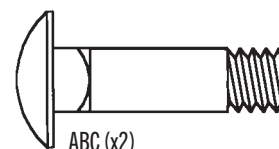

ABC (x2)

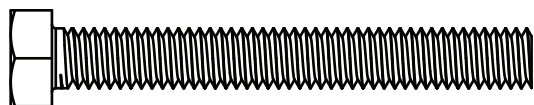

ABG (x2)



ACS (x2)

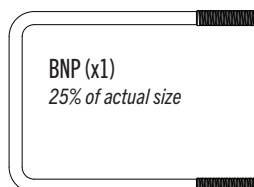

BNP (x1)  
25% of actual size



AOW (x1)  
25% of actual size



AJW (x2)  
25% of actual size

- For model 90718, use the U-bolt that came with the 9594 mounting kit.



## PARTS REQUIRED

## 9594 PARTS:

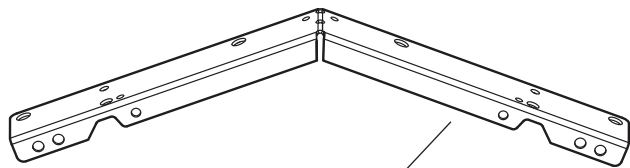

ESF (x2)

More parts come with the 9594 kit, but only the parts used in this section are shown here.

COMBO KIT METAL-FRAMED  
BACKBOARD FROM MODELS 79910,  
73729, 71526, 90087, 90010 AND  
90718

## METAL PARTS

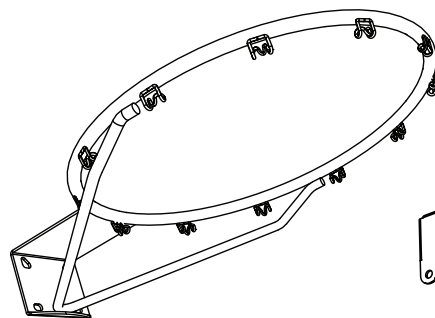
ALX (x1)  
Slam-It™

OR

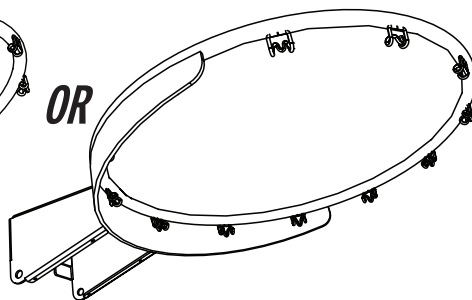
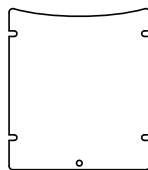
ALX (x1)  
Slam-It™ Pro

AMA (x1)

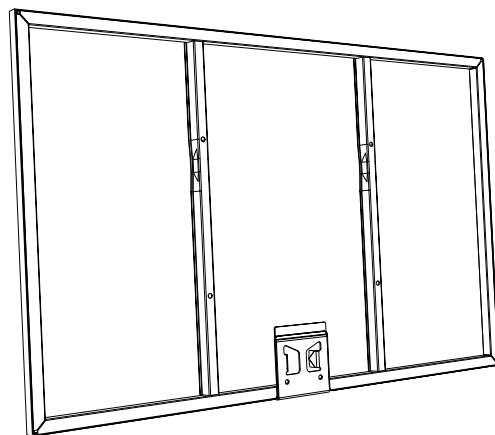

AJI (x1)

Corner guards and frame pads not shown

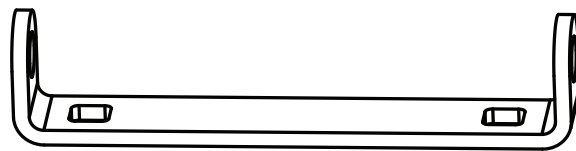

APY (x1)

## PLASTIC PARTS

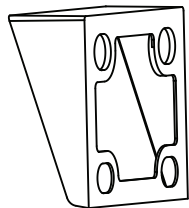

ALD (x1)



AJQ (x1)

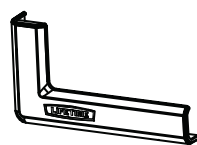

BAA (x1)

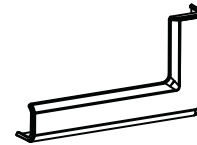

BAB (x1)



## TOOLS REQUIRED

7/16" (≈11 mm)  
(x2)1/2" (≈13 mm)  
(x1)

(x1)



(x1)



(x2)



(x1)

## ► SECTION 3 (CONTINUED)

### TOOLS AND HARDWARE REQUIRED

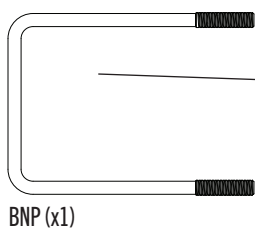
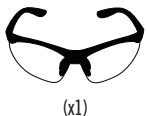

- Use the U-bolt included with your purchased backboard and rim combo.

## 3.1

- **IMPORTANT: USE THE U-BOLT THAT CAME WITH YOUR PURCHASED BACKBOARD AND RIM COMBO.**  
Insert the U-bolt (BNP) through the holes in the backboard brackets (ESF) as indicated.

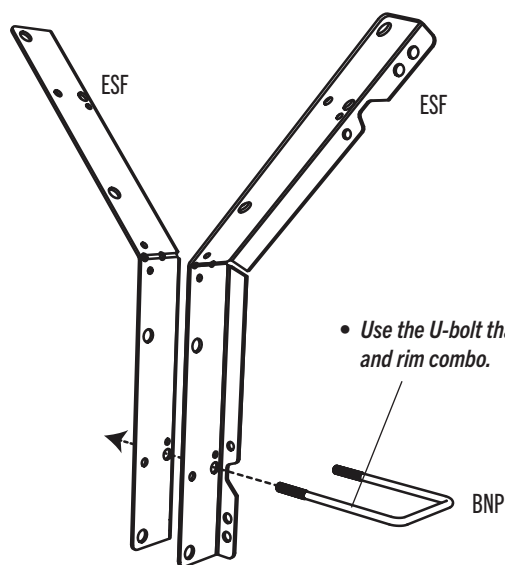

## 3.2

- Rotate the U-bolt as shown. It should rest in the notches.

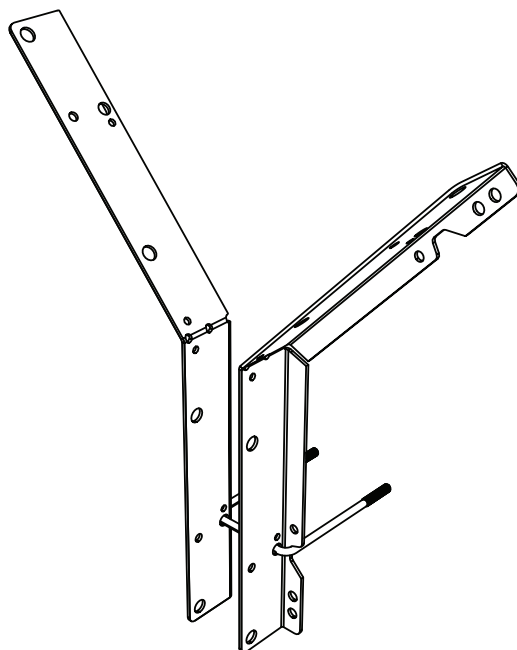

## ► SECTION 3 (CONTINUED)

### TOOLS AND HARDWARE REQUIRED



7/16" (≈11 mm)  
(x2)



(x1)

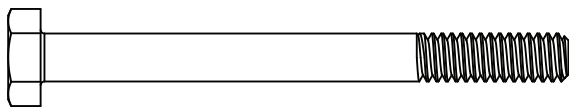

AAS (x2)

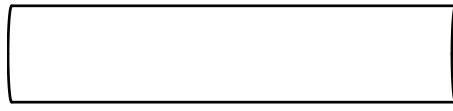

ABS (x2)

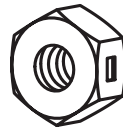

AAB (x2)

## 3.3

- Position the **spacers (ABS)** between the **backboard brackets (ESF)**, ensuring they are aligned with the correct holes in the brackets. Slide a **hex bolt (AAS)** through the brackets and each spacer, and secure them with **centerlock nuts (AAB)**. Now let's attach these backboard brackets to the backboard and rim combo.

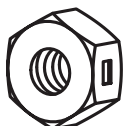
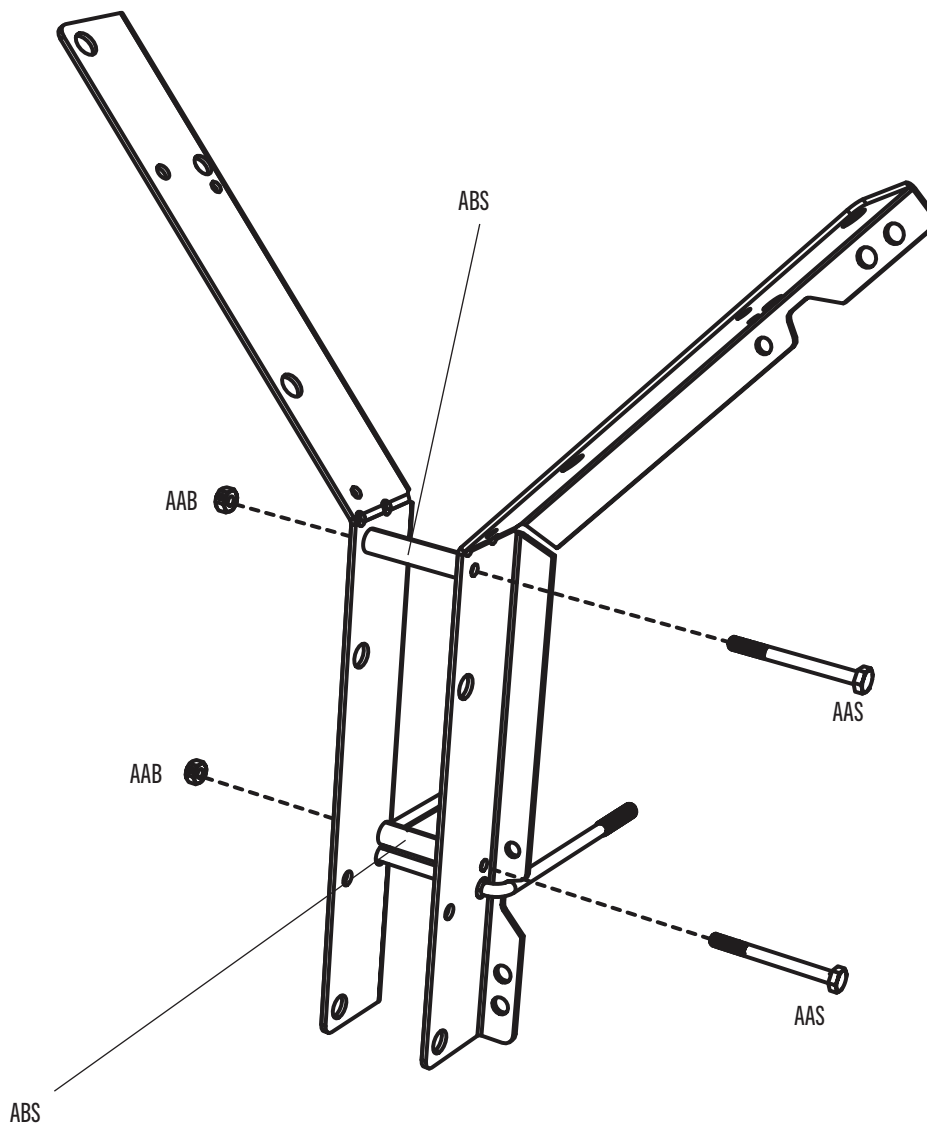

- These nuts are centerlock nuts. They are designed to be tight; therefore, they will be harder to tighten. Tighten until the spacers are flush with the backboard brackets.*

## SECTION 3 (CONTINUED)

### TOOLS AND HARDWARE REQUIRED



1/2" (≈13 mm)  
(x1)



(x1)

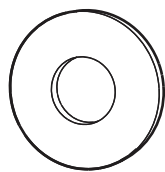

ABD (x2)

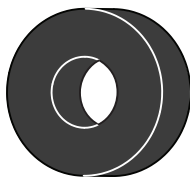

ABF (x2)

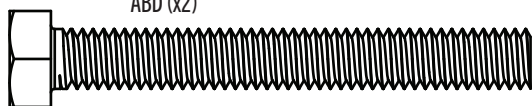

ABG (x2)

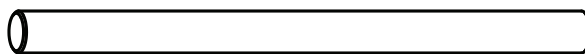

ABQ (x1)

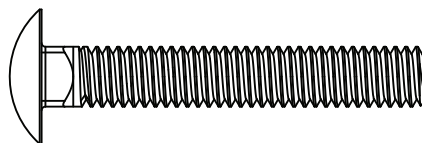

AAR (x2)

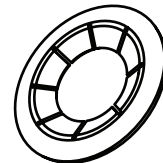

AAQ (x1)

## 3.4

### METAL-FRAMED BACKBOARD-TO-RIM-AND-BACKBOARD BRACKETS ASSEMBLY

Metal-frame backboard—will have one of two types of rims: Slam-it® or Slam-it® Pro

- Insert two (2) bolts (ABG or AAR) through the two (2) washers (ABD) or pivot bracket (APY) as indicated.

#### • Slam-It™ Rim

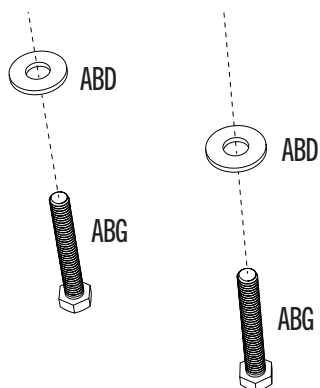

#### • Slam-It™ Pro Rim

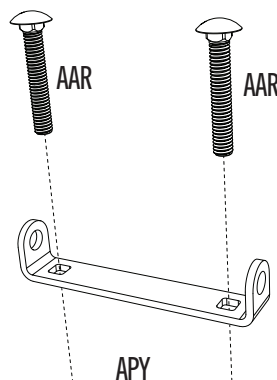

## 3.5

- Slam-It®:** Slide one (1) rubber washer (ABF) onto each bolt.

**Slam-It® Pro:** Use a 1/2" (≈13 mm) socket to press one push nut (AAQ) onto one end of the axle (ABQ) 1/4" (≈6,4 mm).

#### • Slam-It™ Rim

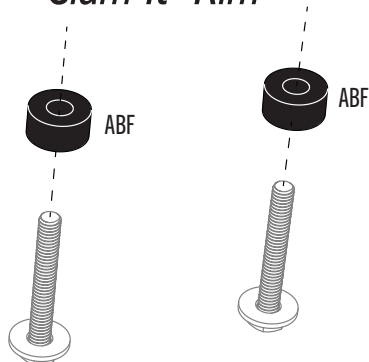

#### • Slam-It™ Pro Rim

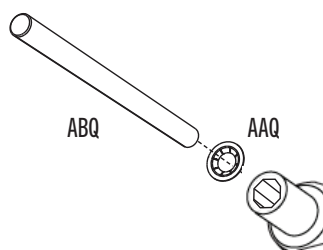

1/2" (≈13 mm) Socket

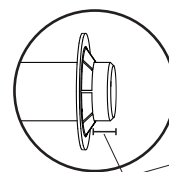

1/4" (≈6,4 mm)



- If the push nut slips on too far, continue sliding it to the other end of the axle to remove it and try again.

## ► SECTION 3 (CONTINUED)

### TOOLS AND HARDWARE REQUIRED



1/2" (≈13 mm)  
(x1)



(x1)

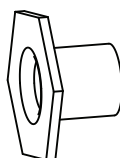

AAJ (x2)

# 3.6

- Slide the pivot assembly into the housing of the **Slam-It® Pro rim (ALX)** and align the holes as indicated.

### • Slam-It™ Rim

NO IMAGE HERE

### • Slam-It™ Pro Rim

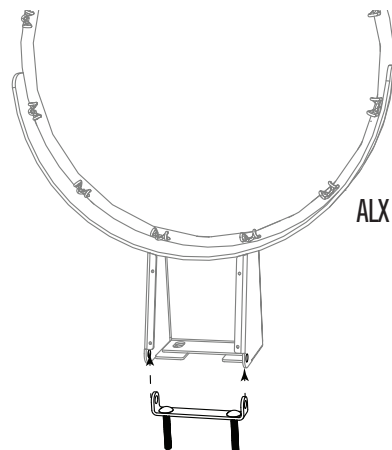

# 3.7

- Slam-It®:** Insert the bolt assemblies through the holes in the rim and secure with two (2) T-nuts (AAJ).
- Slam-It® Pro:** Slide the axle assembly through the housing and the pivot assembly as indicated.

### • Slam-It™ Rim

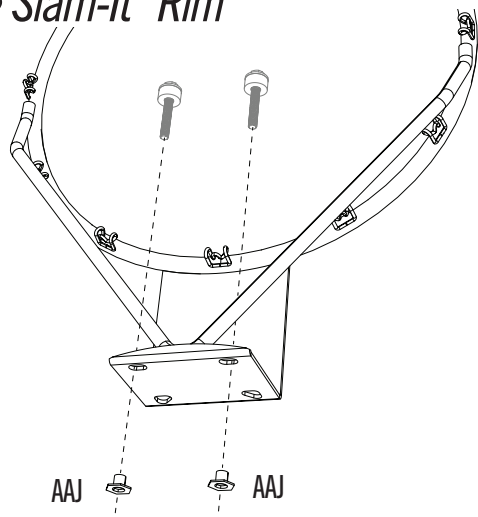

### • Slam-It™ Pro Rim

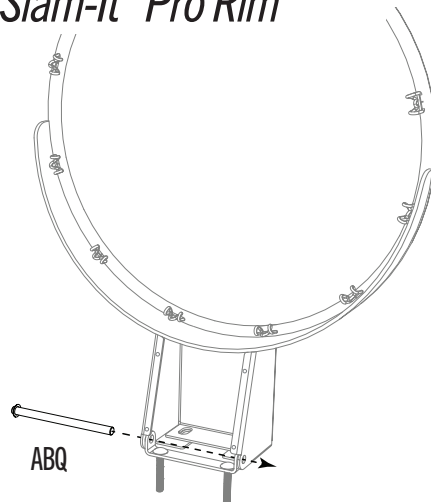



## PARTS IDENTIFIER (FIND YOUR RIM AND BACKBOARD TYPES)



## PARTS REQUIRED

### METAL BACKBOARD & RIM PARTS

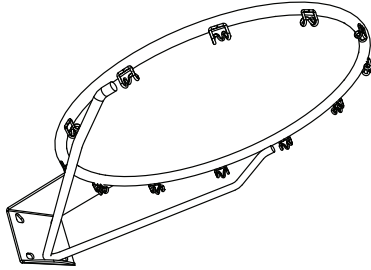

ALX (x1)

OR

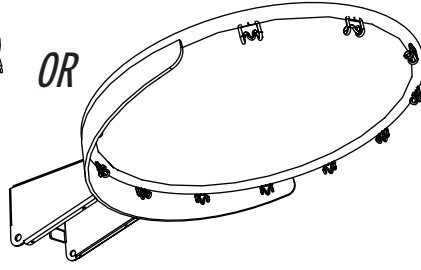

ALX (x1)

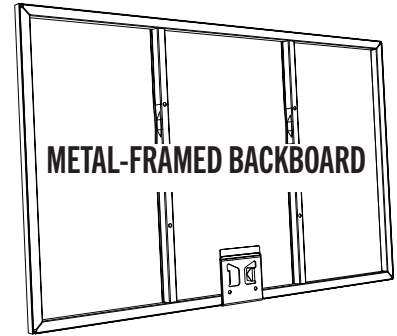

AJI (x1)

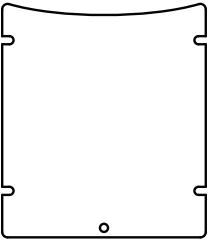

AMA (x1)



AOX (x1)

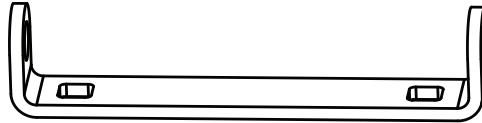

APY (x1)

### PLASTIC BACKBOARD & RIM PARTS

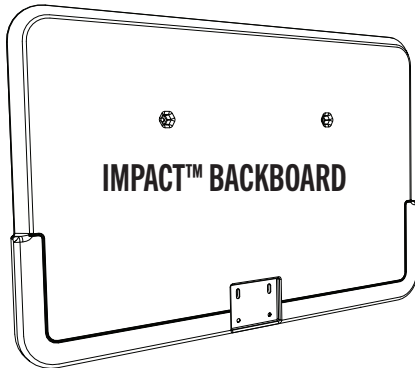

AJI (x1)

OR



AJQ (x1)

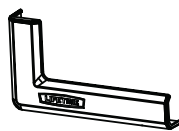

BAA (x1)

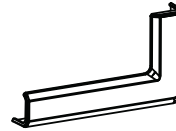

BAB (x1)

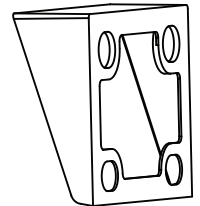

ALD (x1)

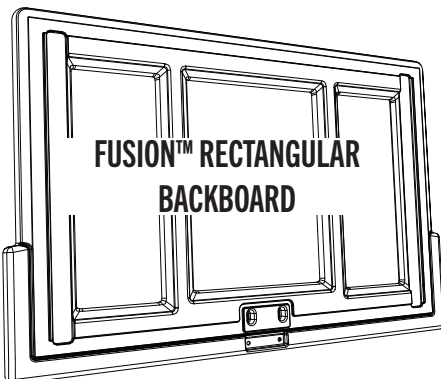

AJI (x1)

OR

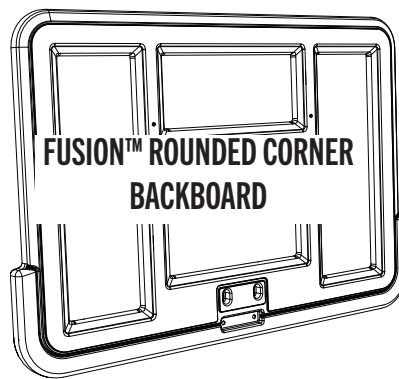

AJI (x1)

Detach this section for use as a quick reference / Détacher cette section pour l'utiliser comme une référence rapide / Despegar esta sección para usarla como una referencia rápida



**PARTS IDENTIFIER (YOU WON'T USE EVERY PIECE—ONLY THOSE REQUIRED FOR YOUR MOUNT TYPE)**



**KIT PARTS & HARDWARE REQUIRED (YOU WON'T USE EVERY PART—ONLY THOSE REQUIRED FOR YOUR MOUNT TYPE)**

## KIT 9594 PARTS



ESJ (x4)

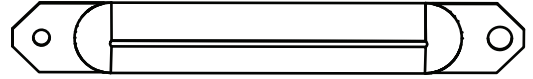

ESI (x2)

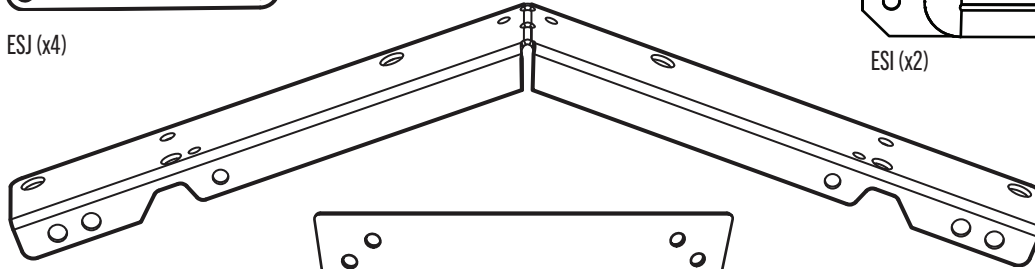

ESF (x2)



ESA (x2)

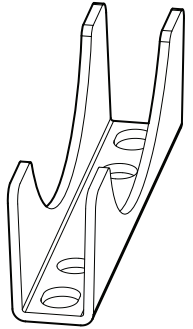

CZZ (x2)

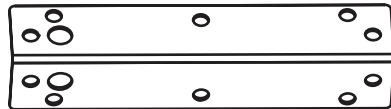

ESH (x4)

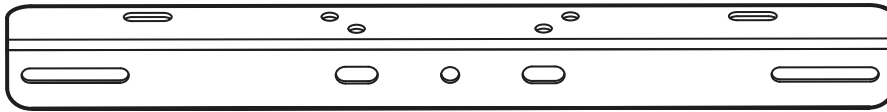

ESG (x2)

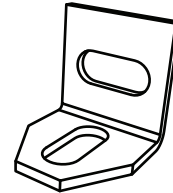

DZS (x2)

- Needed only need for a roof installation

## 9594 KIT HARDWARE

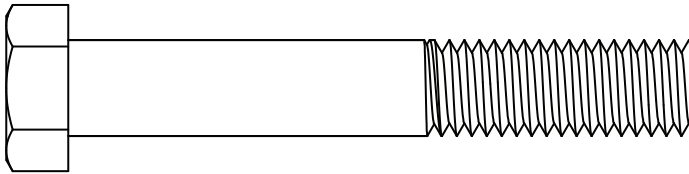

CZY (x2)

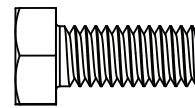

APJ (x14)

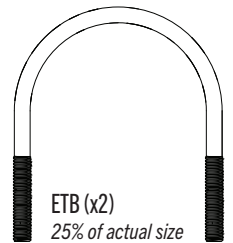

ETB (x2)  
25% of actual size

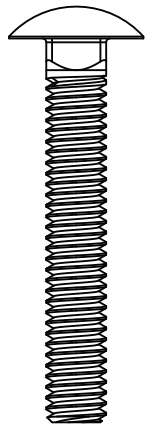

AAR (x2)

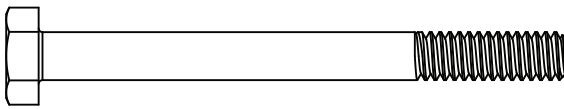

AAS (x2)



AAA (x4)

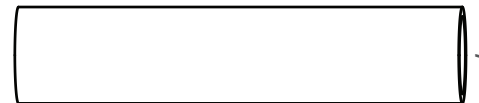

ABS (x2)

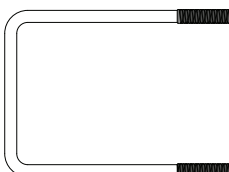

BNP (x1)  
25% of actual size

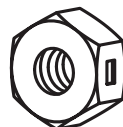

AAB (x2)

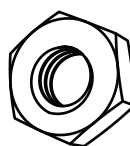

AAV (x2)

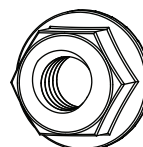

APN (x16)

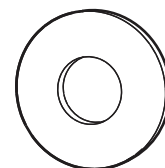

ABD (x14)

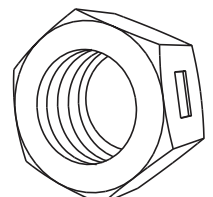

AAX (x2)

Detach this section for use as a quick reference / Détacher cette section pour l'utiliser comme une référence rapide / Despegar esta sección para usarla como una referencia rápida





## PARTS IDENTIFIER



BACKBOARD & RIM COMBO HARDWARE REQUIRED (FIND YOUR MODEL)

### HARDWARE BAG FROM IMPACT™ MODELS 3823 AND 90703

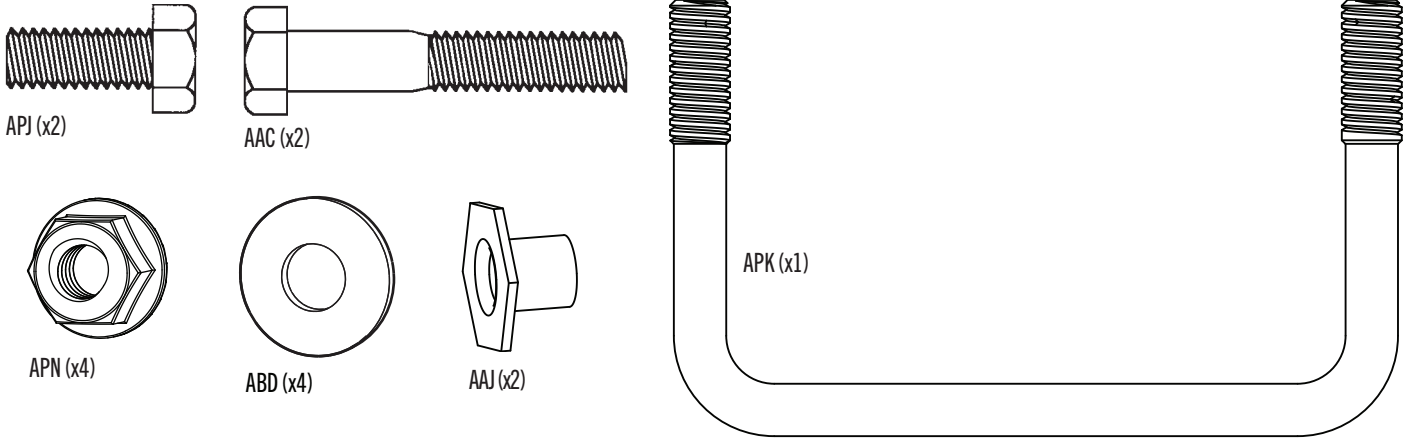

### HARDWARE BAG FROM FUSION™ MODELS 90086, 73650 AND 73621

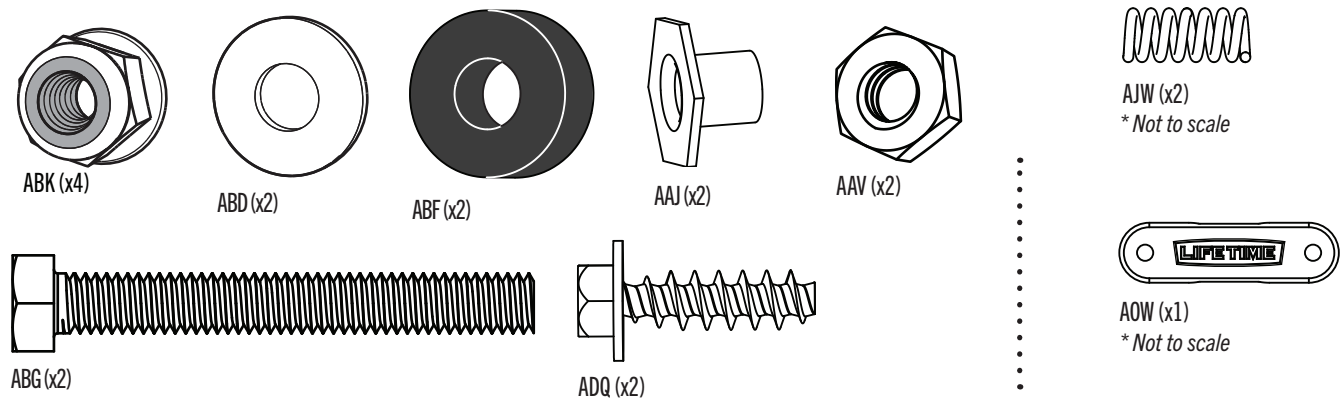

### HARDWARE BAG FROM METAL-FRAMED MODELS 79910, 73729 AND 71526

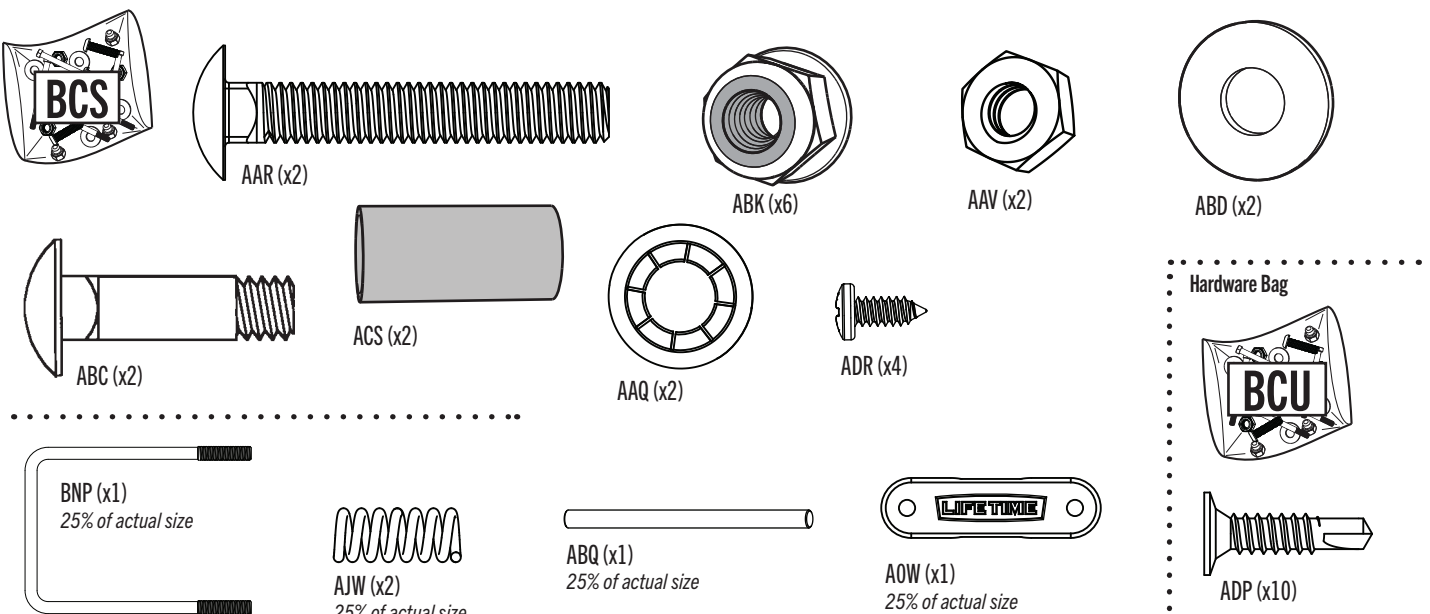



## PARTS IDENTIFIER



## BACKBOARD & RIM COMBO HARDWARE REQUIRED (FIND YOUR MODEL)

### HARDWARE BAG FROM METAL-FRAMED MODELS 90087 AND 90010

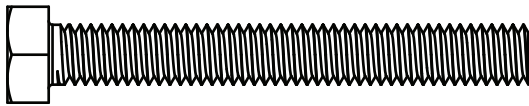

ABG (x2)

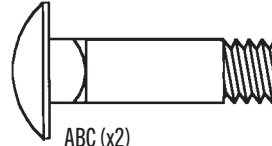

ABC (x2)



ACS (x2)



ABK (x6)\*

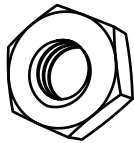

AAV (x2)

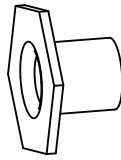

AAJ (x2)

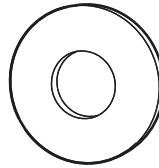

ABD (x2)

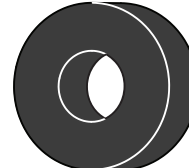

ABF (x2)



\* Hardware Bag BCS contains hardware that may not be used.



A0W (x1)  
25% of actual size



AJW (x2)  
25% of actual size

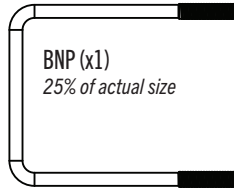

BNP (x1)  
25% of actual size

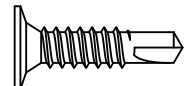

ADP (x10)

### HARDWARE BAG FROM METAL-FRAMED MODEL 90718

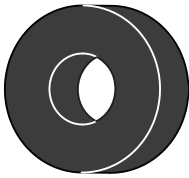
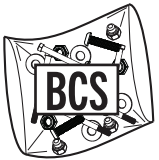

ABF (x2)

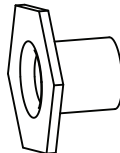

AAJ (x2)

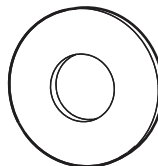

ABD (x2)

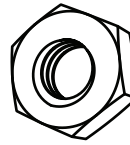

AAV (x2)



ABK (x6)

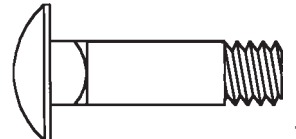

ABC (x2)

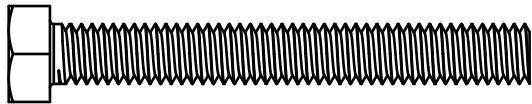

ABG (x2)



ACS (x2)

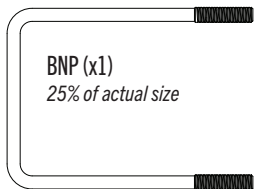

BNP (x1)  
25% of actual size



A0W (x1)  
25% of actual size



AJW (x2)  
25% of actual size

- Use the U-bolt that came with the 9594 mounting kit. See page i.

Detach this section for use as a quick reference / Détacher cette section pour l'utiliser comme une référence rapide / Despegar esta sección para usarla como una referencia rápida

## ► SECTION 3 (CONTINUED)

### TOOLS AND HARDWARE REQUIRED



1/2" (≈13 mm)  
(x1)



(x1)

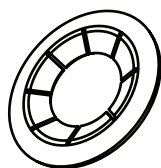

AAQ (x1)

# 3.8

- Use the 1/2" (≈13 mm) socket to press the second **push nut (AAQ)** 1/4" (≈6,4 mm) onto the other end of the axle to lock the pin in place.

### • Slam-It™ Rim

NO IMAGE HERE

### • Slam-It™ Pro Rim

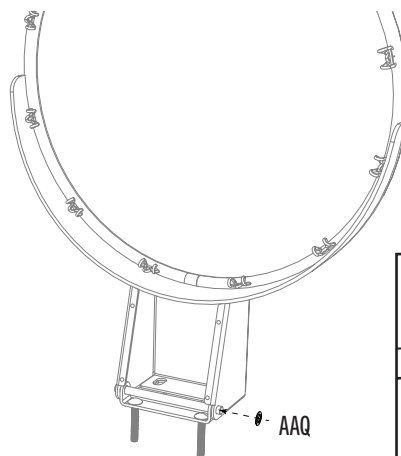

# 3.9

- Slam-It™ and Slam-It™ Pro:** Slide the **finger guard (ALD)** over the bolts as indicated.

### • Slam-It™ Rim

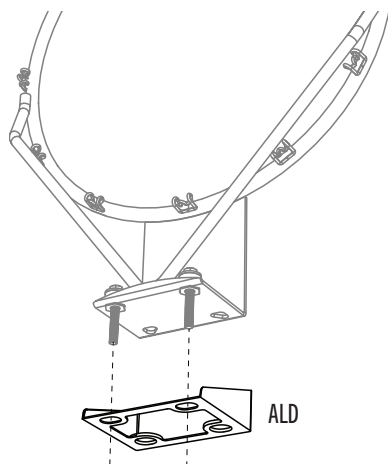

### • Slam-It™ Pro Rim

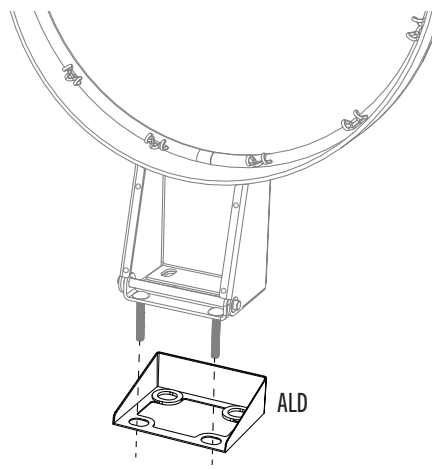

## SECTION 3 (CONTINUED)

### TOOLS AND HARDWARE REQUIRED



1/2" (≈13 mm)  
(x1)



(x2)



ABK (x2)



ACS (x2)

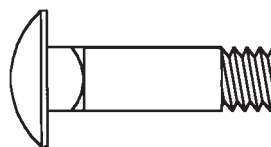

ABC (x2)

# 3.10



- The **Slam-It™** and **Slam-It™ Pro** rims connect to the backboard in the same way. Lay the backboard on a table or bench. Insert the U-bolt through the two upper openings on the backside of the backboard, down through the holes in the **finger guard (ALD)** and through the two holes in the rim as indicated. The bolts on the rim go through the finger guard, the backboard, the two spacers and through the two backboard brackets. Secure the two bolts with nuts (ABK). Be sure to insert the spacers (ACS) between the backboard brackets and the backboard.

### • Slam-It™ Rim

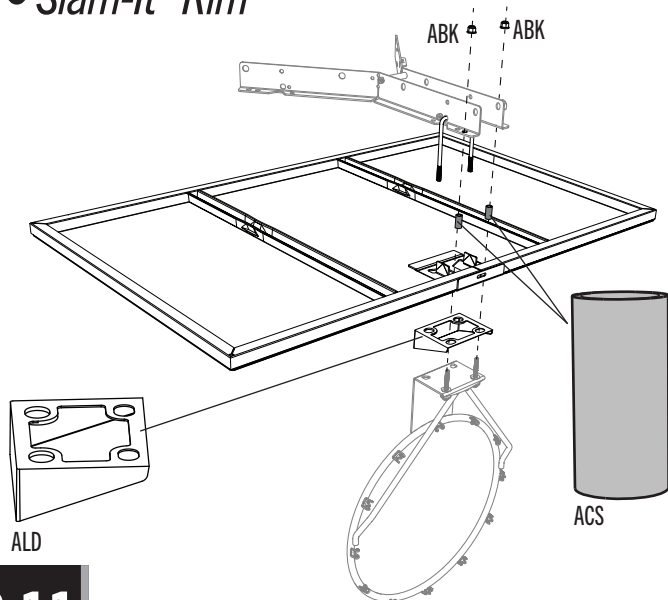

### • Slam-It™ Pro Rim

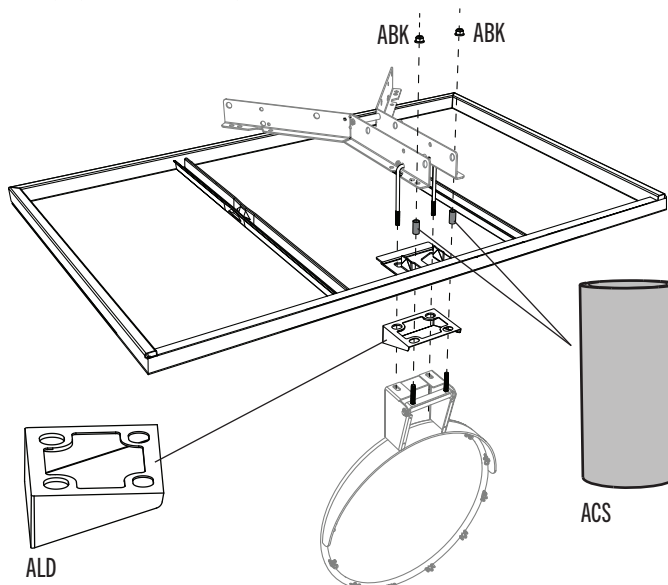

# 3.11



- Slide the head of a **bolt (ABC)** inside the track and under the two ridges as indicated. Lift the backboard bracket over the bolt and slide the end of the bolt into the hole in the bracket. Repeat this step for the other track.

### • Slam-It™ Rim

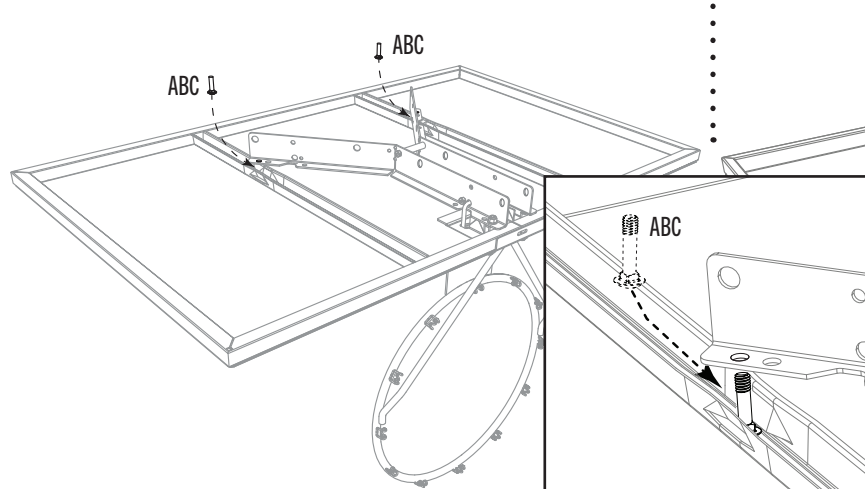

### • Slam-It™ Pro Rim

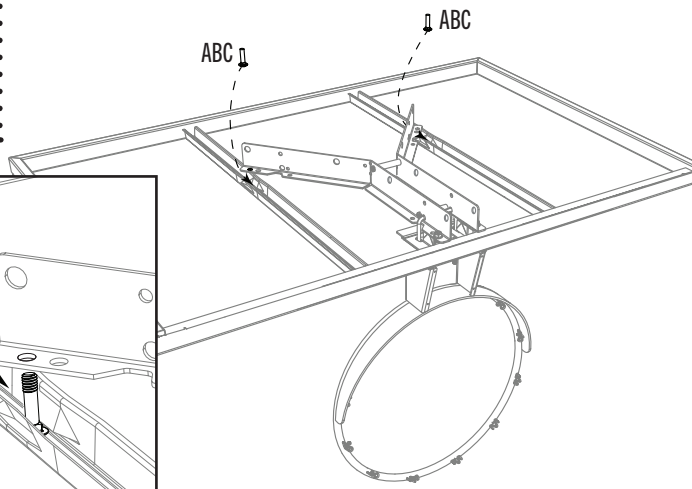

## SECTION 3 (CONTINUED)

### TOOLS AND HARDWARE REQUIRED



1/2" (≈13 mm)  
(x1)



(x2)



ABK (x4)



DZS (x2)

- Needed only need for a roof installation

## 3.12a



- If you are installing kit 9594 to a roof, follow this step (3.12a):

- Attach an angle brace (DZS) to the backboard bracket and backboard using one nut (ABK). Repeat for the other side. Leave both braces loose until instructed.

- *Slam-It™ Rim*

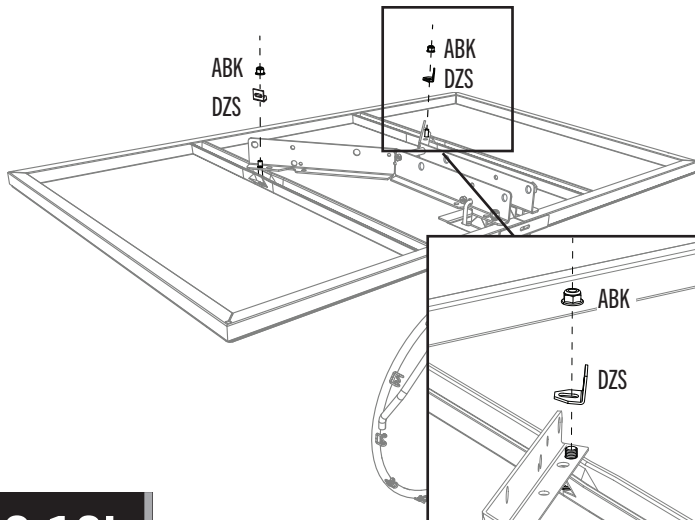

- *Slam-It™ Pro Rim*

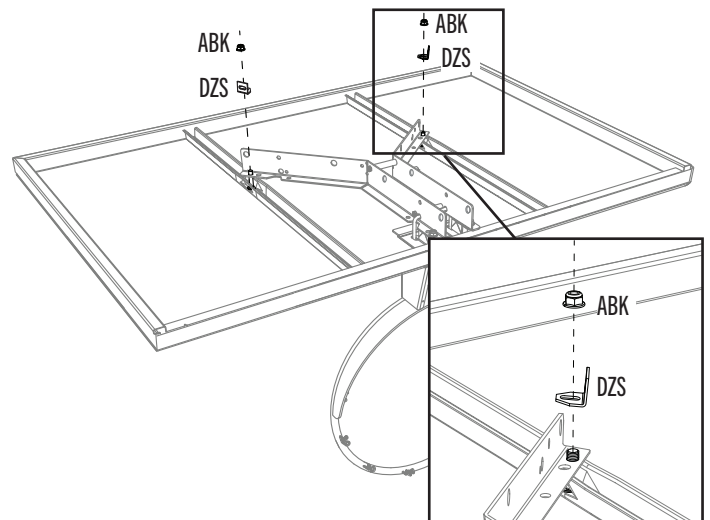

## 3.12b



- If you are installing kit 9594 to a pole or wall, follow this step (3.12b):

- Secure the backboard brackets to the backboard at the locations indicated using the hardware provided.  
DO NOT use an angle brace if you are not installing this system to your roof.

- *Slam-It™ Rim*

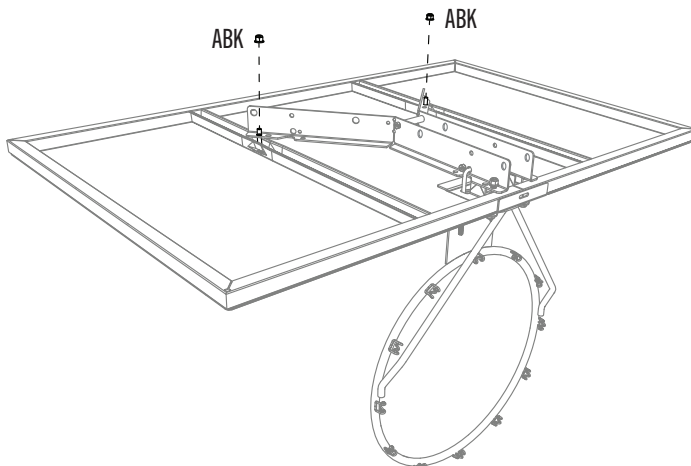

- *Slam-It™ Pro Rim*

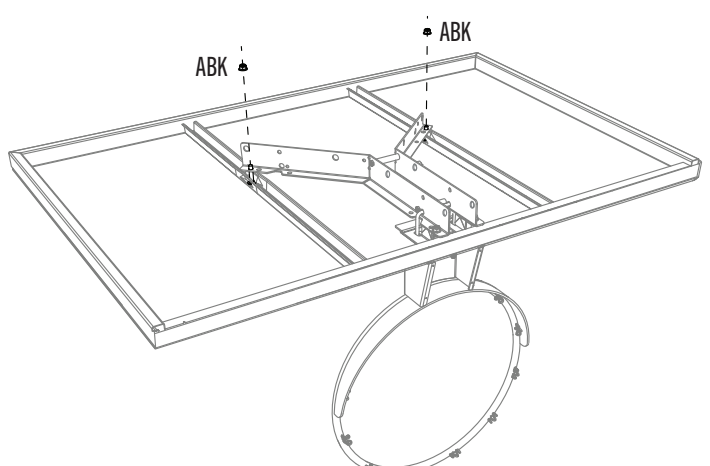

## SECTION 3 (CONTINUED)

### TOOLS AND HARDWARE REQUIRED



1/2" (≈13 mm)  
(x1)



(x2)

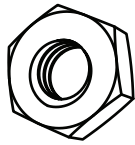

AAV (x2)



ABK (x2)



AOW (x1)



AJW (x2)

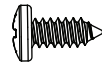

ADR (x4)

## 3.13



- Thread the two **jam nuts (AAV)** over the two ends of the U-bolt as far as they will go. Set a **spring (AJW)** over each end of the U-Bolt. Set the **spring retainer plate (AOW)** over the springs and ends of the U-bolt. Finally, secure the hardware using two **nuts (ABK)**.

### • Slam-It™ Rim

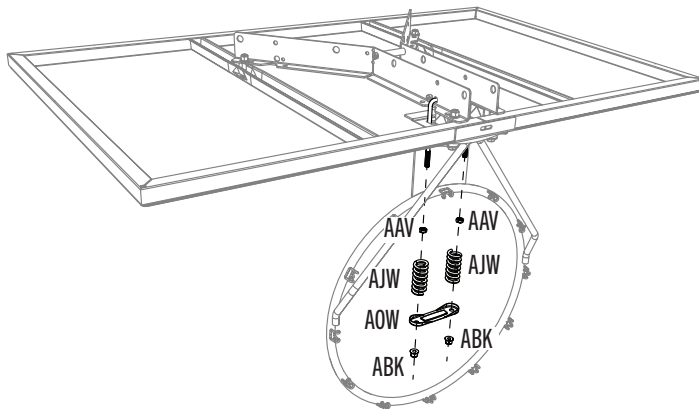

### • Slam-It™ Pro Rim

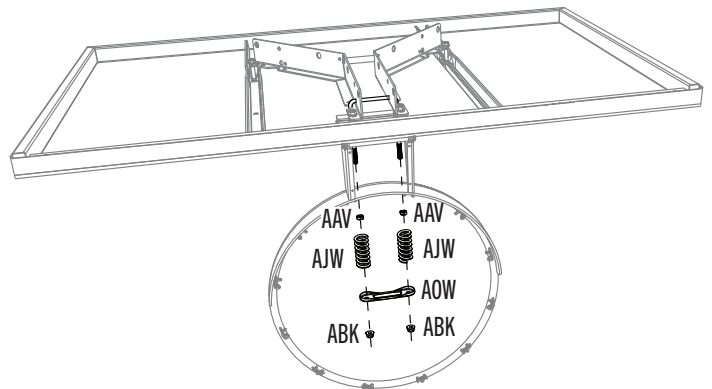

## 3.14

- Attach the **cover plate (AMA)** to the rim hardware housing using four **screws (ADR)**.

### • Slam-It™ Rim

NO IMAGE HERE

### • Slam-It™ Pro Rim

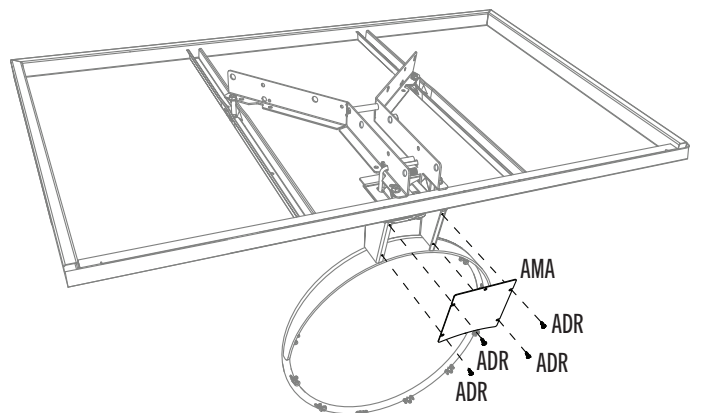



## ► SECTION 3 (CONTINUED)

TOOLS AND HARDWARE REQUIRED



(x1)



ADP (x4)

### 3.15

- Peel the plastic film off the front of the backboard.

#### • *Slam-It™ Rim*

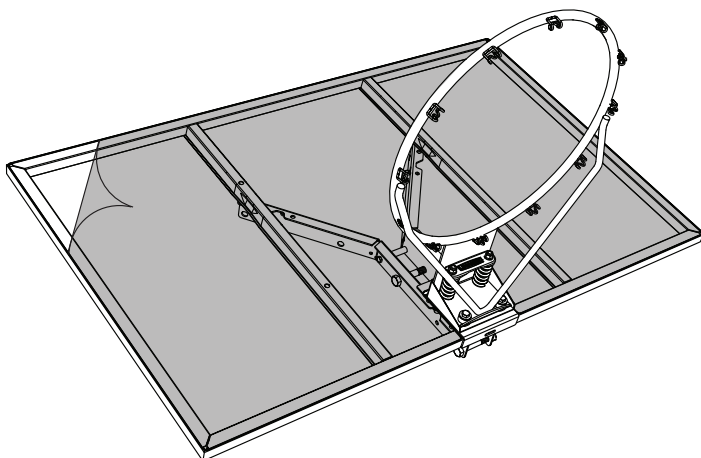

#### • *Slam-It™ Pro Rim*

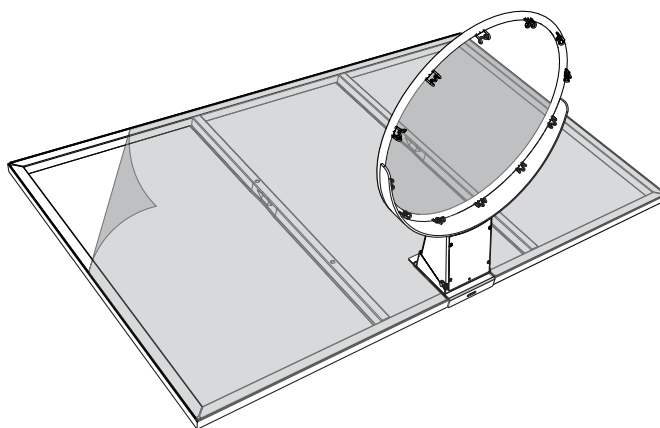

### 3.16

#### SOME MODELS INCLUDE CORNER GUARDS

- If your combo comes with corner guards, they've come pre-installed.

NO IMAGE HERE

#### SOME MODELS INCLUDE FRAME PADS

- If your combo comes with frame pads, do the following:  
Center the **center frame pad (AJQ)** on the bottom of the backboard and secure with four (4) **screws (ADP)**.

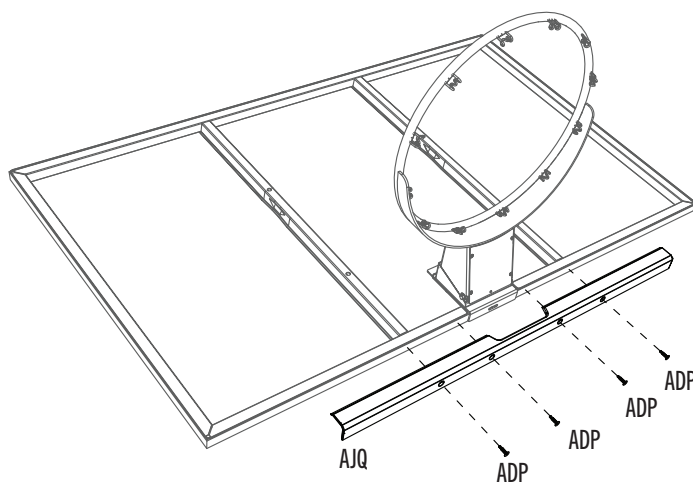

## ► SECTION 3 (CONTINUED)

### TOOLS AND HARDWARE REQUIRED



(x1)

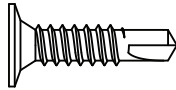

ADP (x6)

## 3.17

- If your combo comes with corner guards, they've come pre-installed.
- Secure the **left** and **right** corner frame pads (**BAA** and **BAB**) to the bottom of the frame, overlapping the center frame pad. **They will overlap the center frame pad.**

NO IMAGE HERE

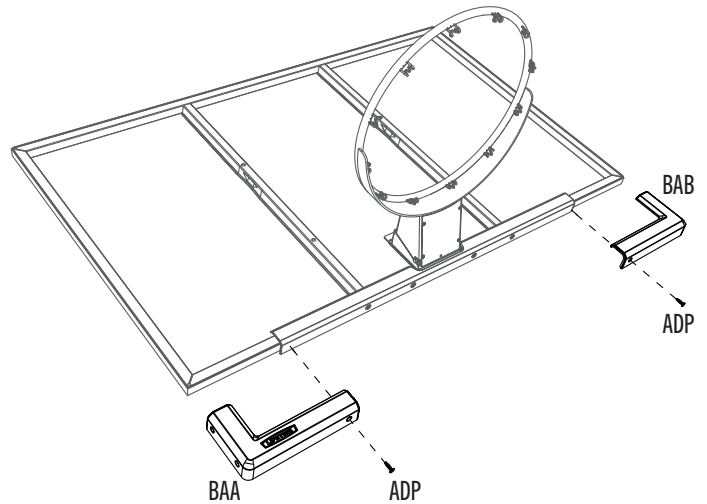

## 3.18

- If your combo came with corner guards, they came pre-installed.
  - Secure the **left** and **right** corner frame pads to the left and right borders of the frame as shown. **Set assembly aside.**
- Now that you're finished assembling the combo,
- go to section 4 for mounting the kit and combo to a pole.
  - go to section 5 for mounting the kit and combo to a roof.
  - go to section 6 for mounting the kit and combo to a wall.

NO IMAGE HERE

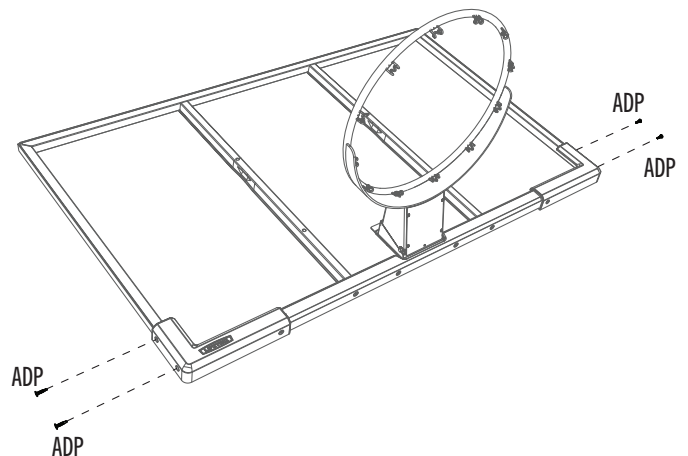



- Section 4 is for mounting a backboard and rim combo to an existing 3 1/2" ( $\approx 8,9$  cm) round pole. If this is your goal, you've come to the right place. The following steps show just how to do this.

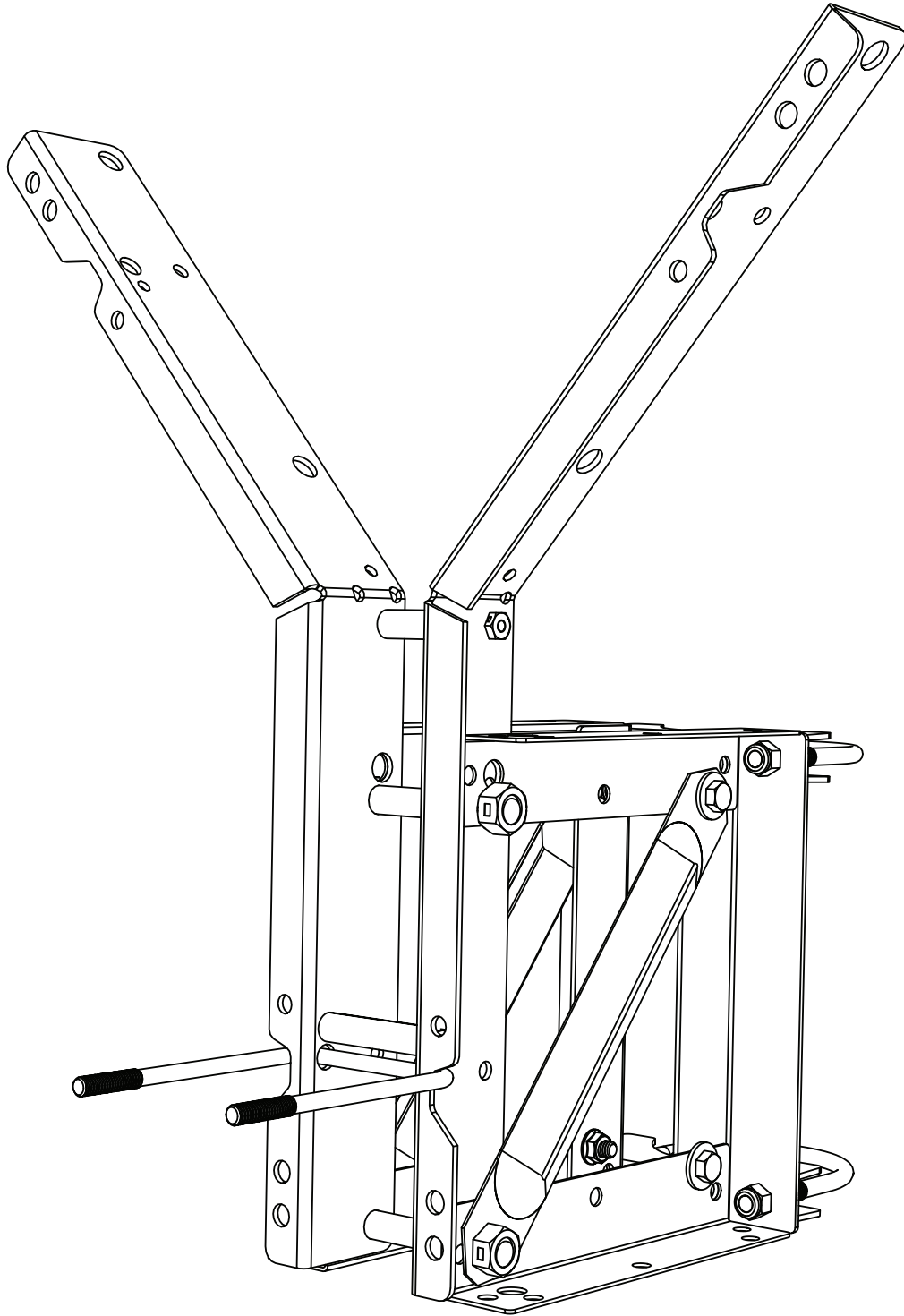

**9594 Mounting Kit Assembly for Poles**

# 4

## POLE-MOUNT ASSEMBLY



### HARDWARE REQUIRED

#### KIT 9594 HARDWARE

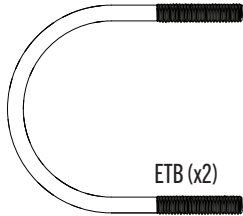

ETB (x2)

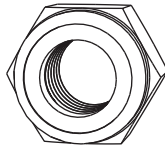

AAA (x4)

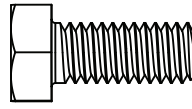

APJ (x4)

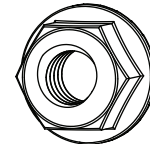

APN (x4)

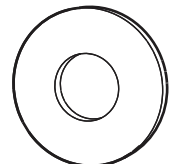

ABD (x4)

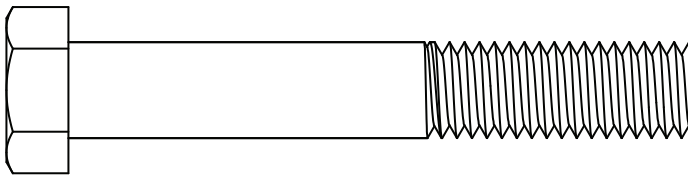

CZY (x2)

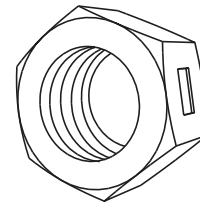

AAX (x2)



### PARTS REQUIRED

#### KIT 9594 METAL PARTS

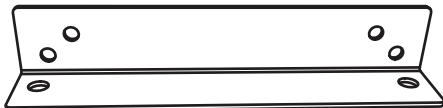

ESA (x2)

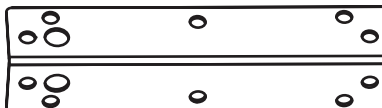

ESH (x4)

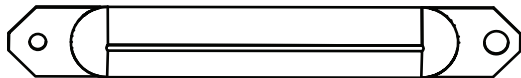

ESI (x2)

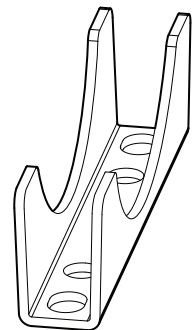

CZZ (x2)



### TOOLS REQUIRED



1/2" (≈13 mm)  
(x2)



9/16" (≈14 mm)  
(x2)



3/4" (≈19 mm)  
(x2)

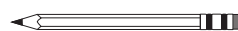

(x1)



(x3)

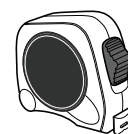

(x1)



(x3)

## SECTION 4 (CONTINUED)

### TOOLS AND HARDWARE REQUIRED

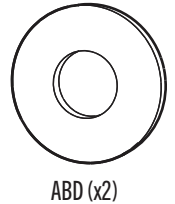
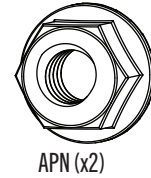
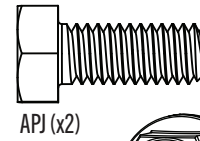
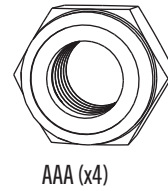
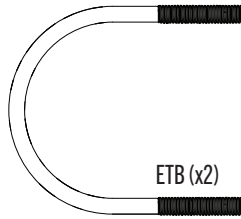
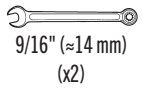
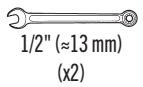

## 4.1



- Make a mark on the pole 115 3/4" (≈294 cm) from the ground. Attach the two U-bolts (ETB) to the saddle brackets (CZZ) and pole mount brackets (ESA) using the hardware indicated, with the bottom of the lower saddle bracket—NOT the pole mount brackets—at the 115 3/4" (≈294 cm) mark. Ensure the saddle brackets (CZZ) are parallel with the edge of the playing surface.

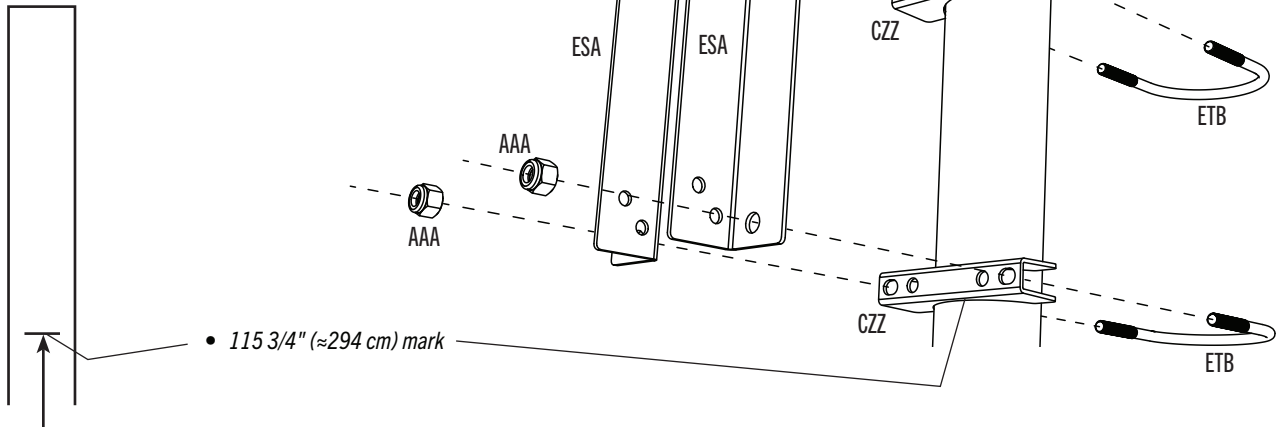

## 4.2



- Place an extension bracket (ESH) at the bottom of a pole mount brackets, attaching the end of the extension bracket to the two smaller holes in the pole mount bracket. Insert a hex bolt (APJ) through a flat washer (ABD) and through the upper of the two holes on the border of the extension bracket and pole mount bracket. Secure the bolt with a flange nut (APN). Repeat for the second extension bracket (ESH).

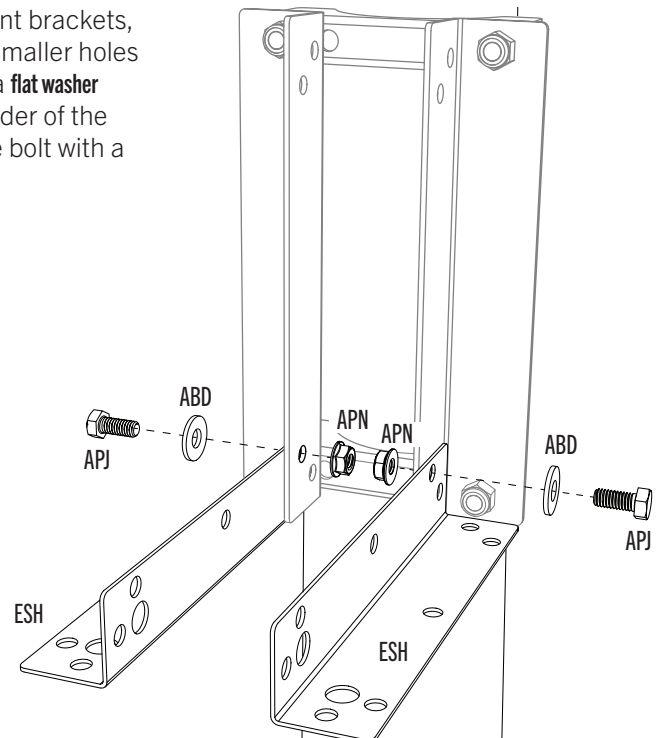

## ► SECTION 4 (CONTINUED)

### TOOLS AND HARDWARE REQUIRED



1/2" (≈13 mm)  
(x2)



(x2)

# 4.3



- Place an **extension bracket (ESH)** at the top of a pole mount bracket. While holding the extension bracket in place, place the end of a **diagonal support (ESI)** next to the extension bracket so the smaller hole in the support aligns with the lower hole in the bracket as indicated. Insert a **bolt (APJ)** through a **washer (ABD)**, the **diagonal support** and the lower hole in the **extension bracket**. Secure the bolt with a **nut (APN)**. Repeat for the other side of the pole mount bracket with the remaining extension bracket and diagonal support.

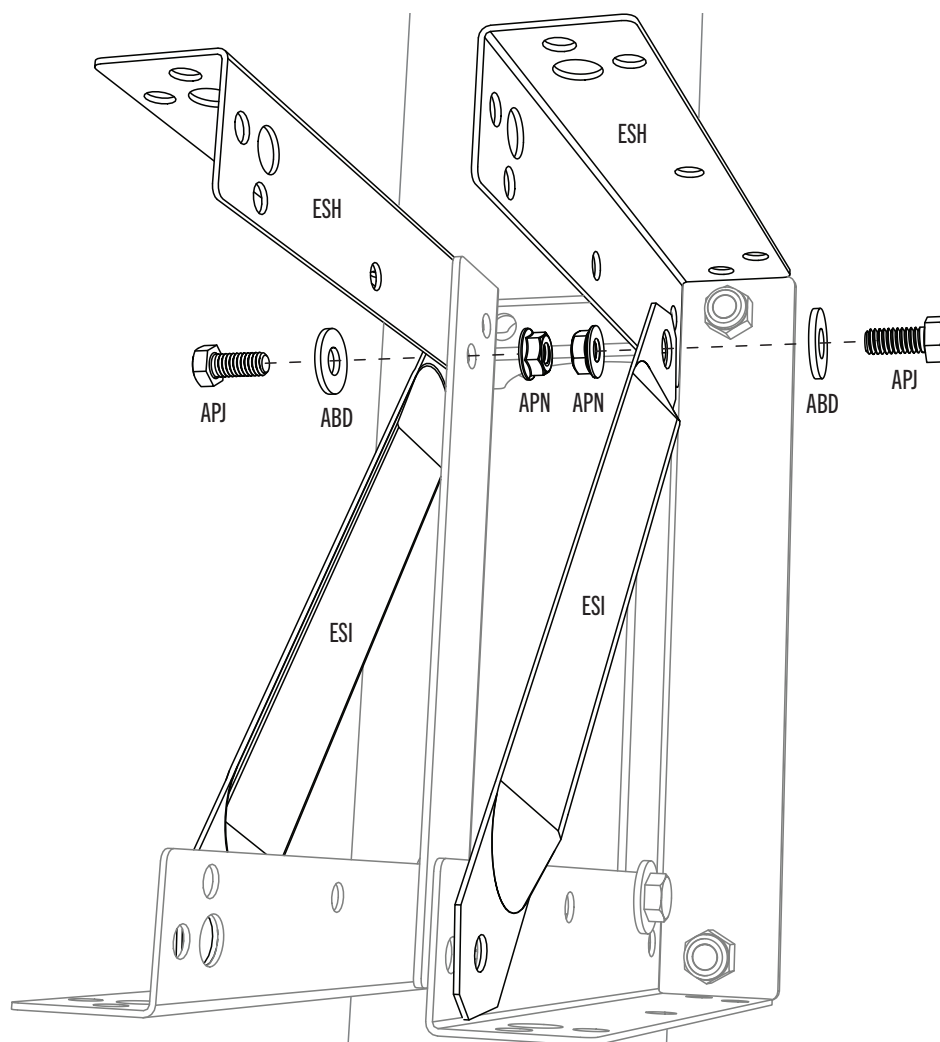

- The diagonal support should attach to the end of the top extension bracket closest to the pole.

## ► SECTION 4 (CONTINUED)

### TOOLS AND HARDWARE REQUIRED



3/4" (≈19 mm)  
(x2)



(x3)

# 4.4

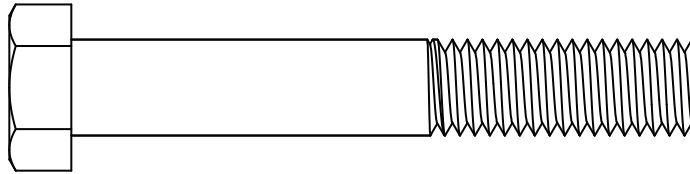

CZY (x2)

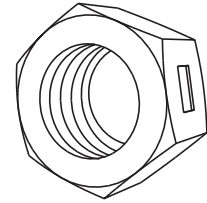

AAX (x2)

In this example, we're mounting a Fusion™ backboard & rim combo to a pole; however, all backboard & rim combos mount to a pole in the same way.

- Carefully lift the backboard up to the pole mount assembly. Align the large holes at the ends of the lower **extension brackets (ESH)** with the bottom holes in the backboard brackets. Align the holes in the **diagonal supports (ESI)** with the holes in both extension brackets. Slide a **hex bolt (CZY)** through the diagonal supports, the extension brackets and the backboard brackets. Secure the bolt with a **centerlock nut (AAX)**. Attach the upper extension brackets to the backboard brackets with another **hex bolt (CZY)** and **centerlock nut (AAX)** as indicated.

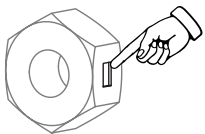
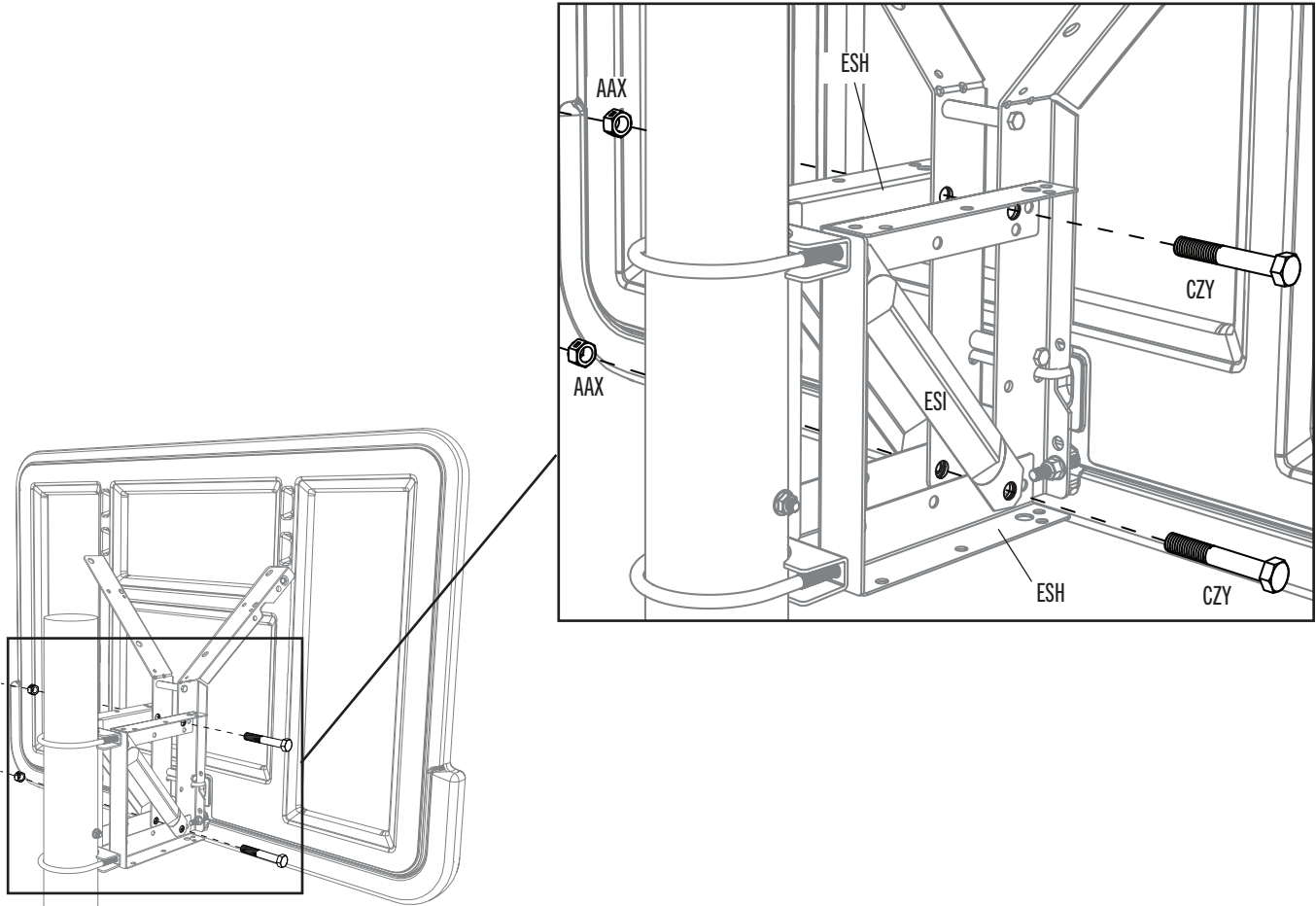

- These nuts are centerlock nuts. They are designed to be tight; therefore, they will be harder to tighten. Tighten until flush with the extension brackets.

- Section 5 is for mounting a backboard and rim combo to a roof. If this is your goal, you've come to the right place. The following instructions show just how to do this.

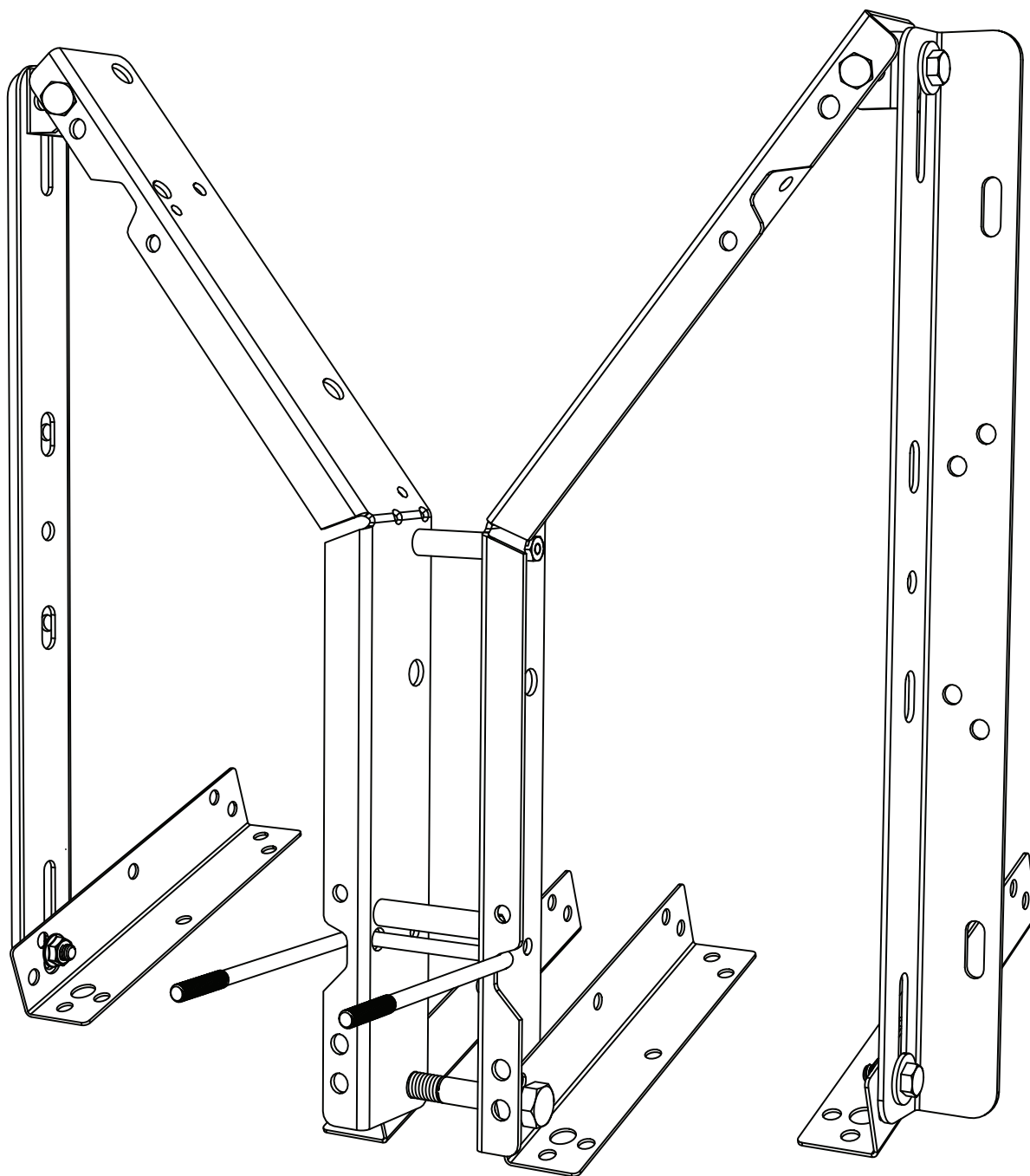

**9594 Mounting Kit Assembly for Rooves**



## HARDWARE REQUIRED

## KIT 9594 HARDWARE

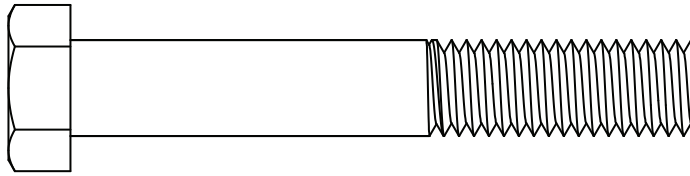

CZY (x1)

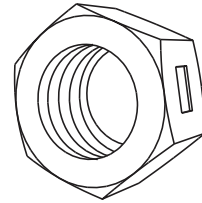

AAX (x1)

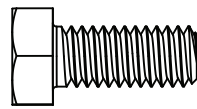

APJ (x4)

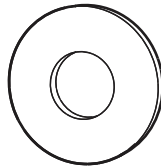

ABD (x4)

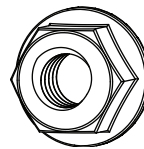

APN (x4)



## PARTS REQUIRED

## KIT 9594 METAL PARTS

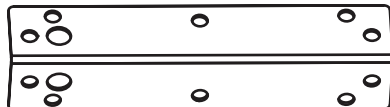

ESH (x4)

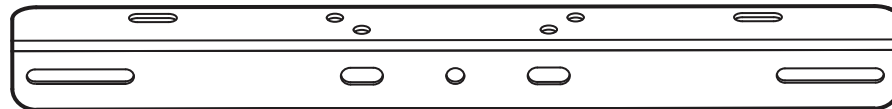

ESG (x2)



## TOOLS REQUIRED

3/4" (≈19 mm)  
(x2)1/2" (≈13 mm)  
(x2)

(x3)



(x2)



(x1)



(x1)

## ► SECTION 5 (CONTINUED)

### TOOLS AND HARDWARE REQUIRED



(x1)



(x1)



(x1)



(x1)



## 5.1

- Place two **extension brackets (ESH)** 2 1/2" (6,35 cm) apart on the edge of the roof. The ends of the brackets with the larger holes should be along the edge of the roof as indicated. **Secure the brackets to the roof, at the locations indicated, with hardware (not included) appropriate for use on a roof.**

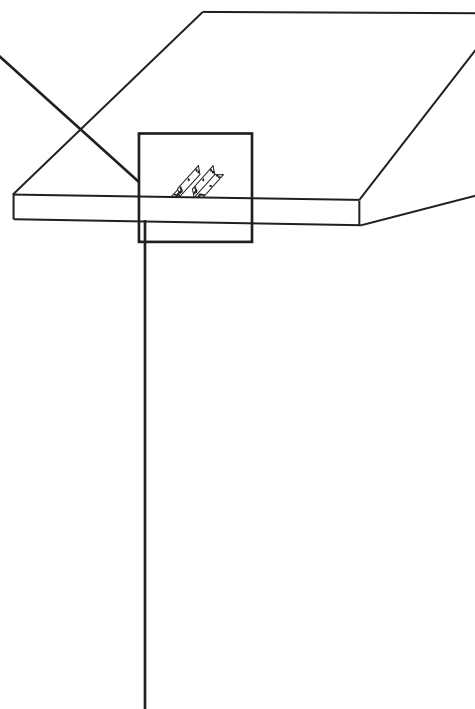
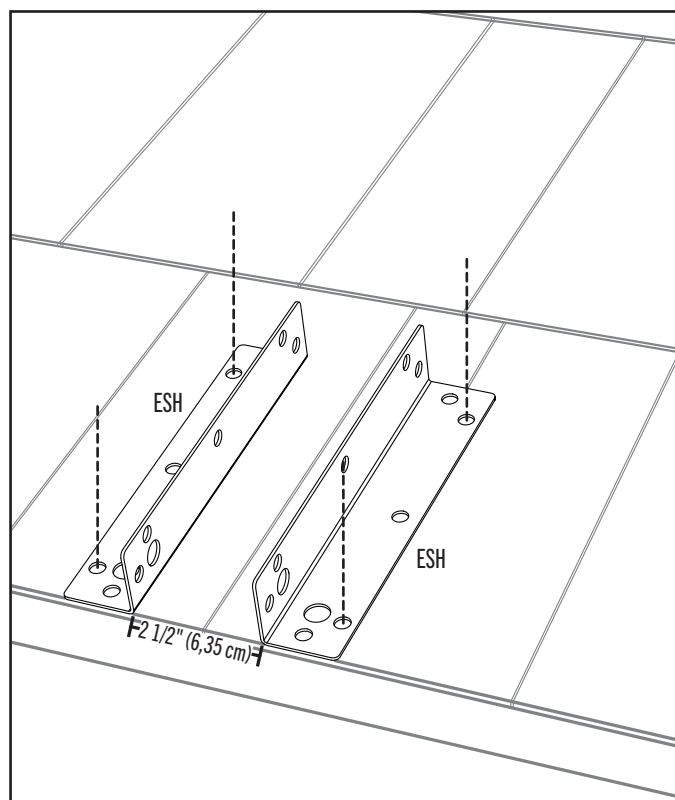



## ► SECTION 5 (CONTINUED)

### TOOLS AND HARDWARE REQUIRED



3/4" (≈19 mm)  
(x2)



(x3)



(x2)

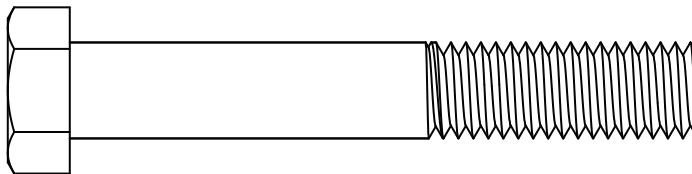

CZY (x1)

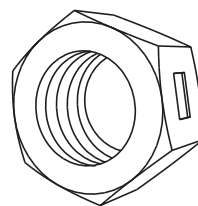

AAX (x1)

## 5.2



In this example, we're mounting a Fusion™ backboard & rim combo to a roof; however, all backboard & rim combos mount to a roof in the same way.

- Lift the backboard to the extension brackets mounted on the roof. Align the larger holes in the extension brackets with the bottom holes in the backboard brackets. Slide a **hex bolt (CZY)** through the extension brackets and backboard brackets. Secure the bolt with a **centerlock nut (AAX)**. **One adult needs to support the backboard until the next step is complete.**

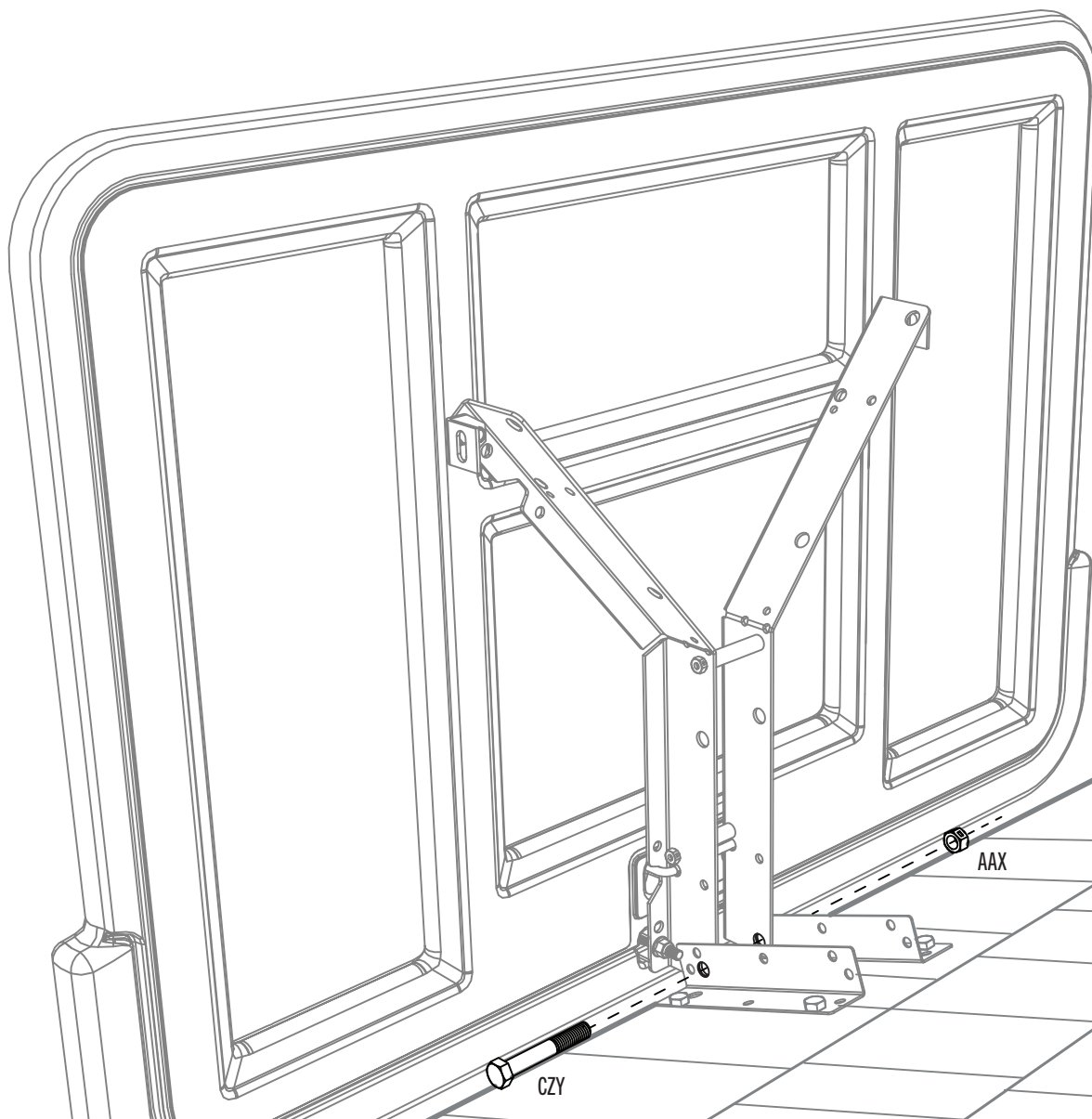

- *These nuts are centerlock nuts. They are designed to be tight; therefore, they will be harder to tighten. Tighten until flush with the extension brackets.*

## SECTION 5 (CONTINUED)

### TOOLS AND HARDWARE REQUIRED



1/2" (≈13 mm)  
(x2)



(x3)



(x2)

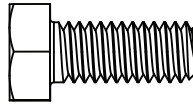

APJ (x4)

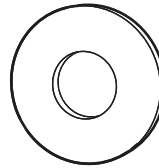

ABD (x4)

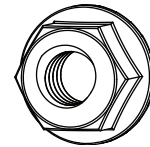

APN (x4)

## 5.3

- Attach through the long slots in the **stud brackets (ESG)** to the upper angle braces (attached in step 1.5a, 2.7a, or 3.12a) on each backboard bracket with a **hex bolt (APJ)**, a **flat washer (ABD)**, and a **flange nut (APN)**.

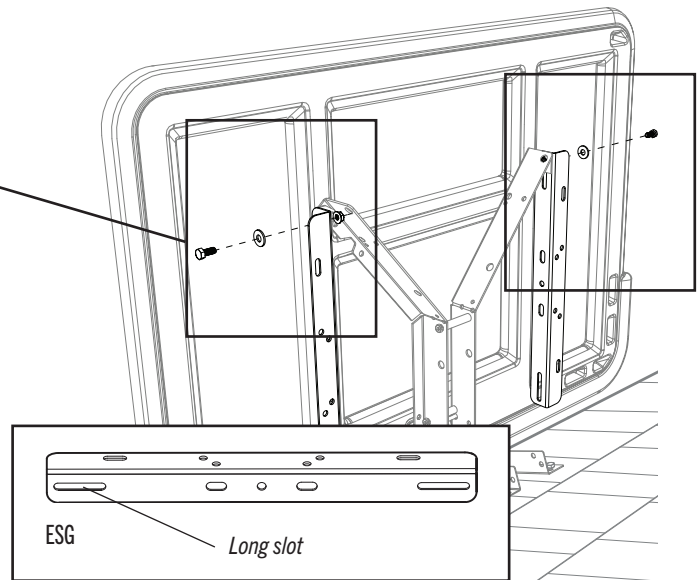
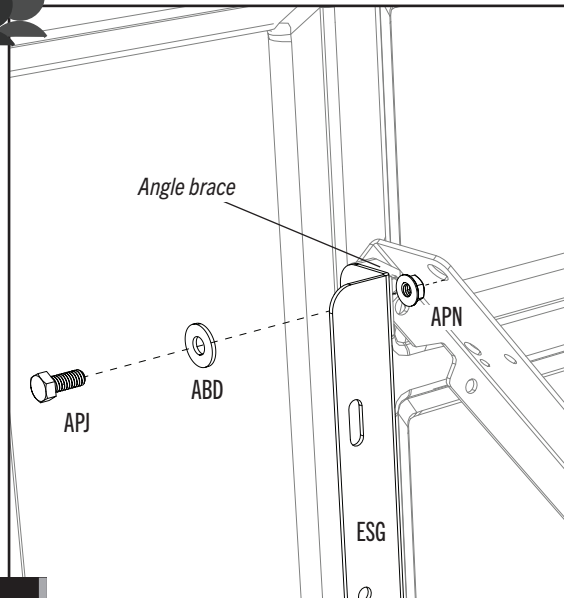

## 5.4

- Insert a **bolt (APJ)** through a **washer (ABD)**, a **stud bracket (ESG)** and an **extension bracket (ESH)** through the holes indicated. Secure with a **nut (APN)**. Repeat for the other extension bracket (ESH). Adjust the backboard until it is vertical, and secure the extension brackets (ESH) to the roof with hardware (not included) appropriate for a roof. Securely tighten the angle brackets from steps 1.6a, 2.7a or 3.12a.



- Adjust the backboard until it is vertical, and secure the extension brackets to the roof with the appropriate hardware (not included).**

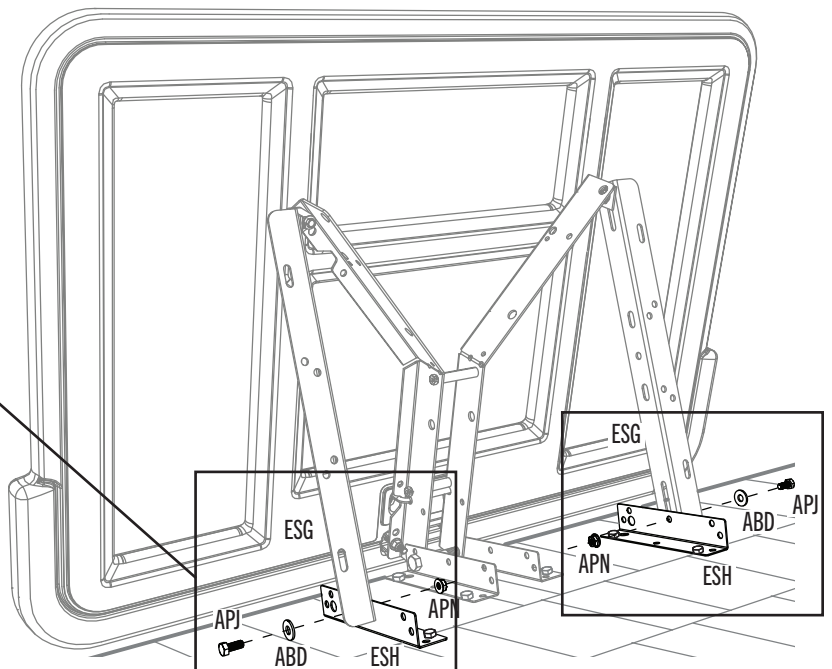
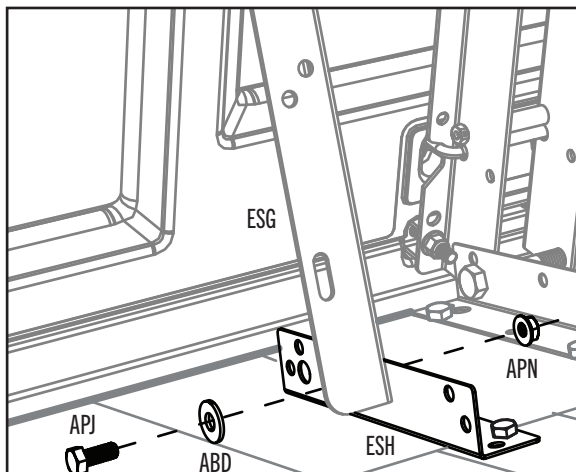

- Section 6 is for mounting a backboard and rim combo to a wall. If this is your goal, you've come to the right place. The following instructions show just how to do this.

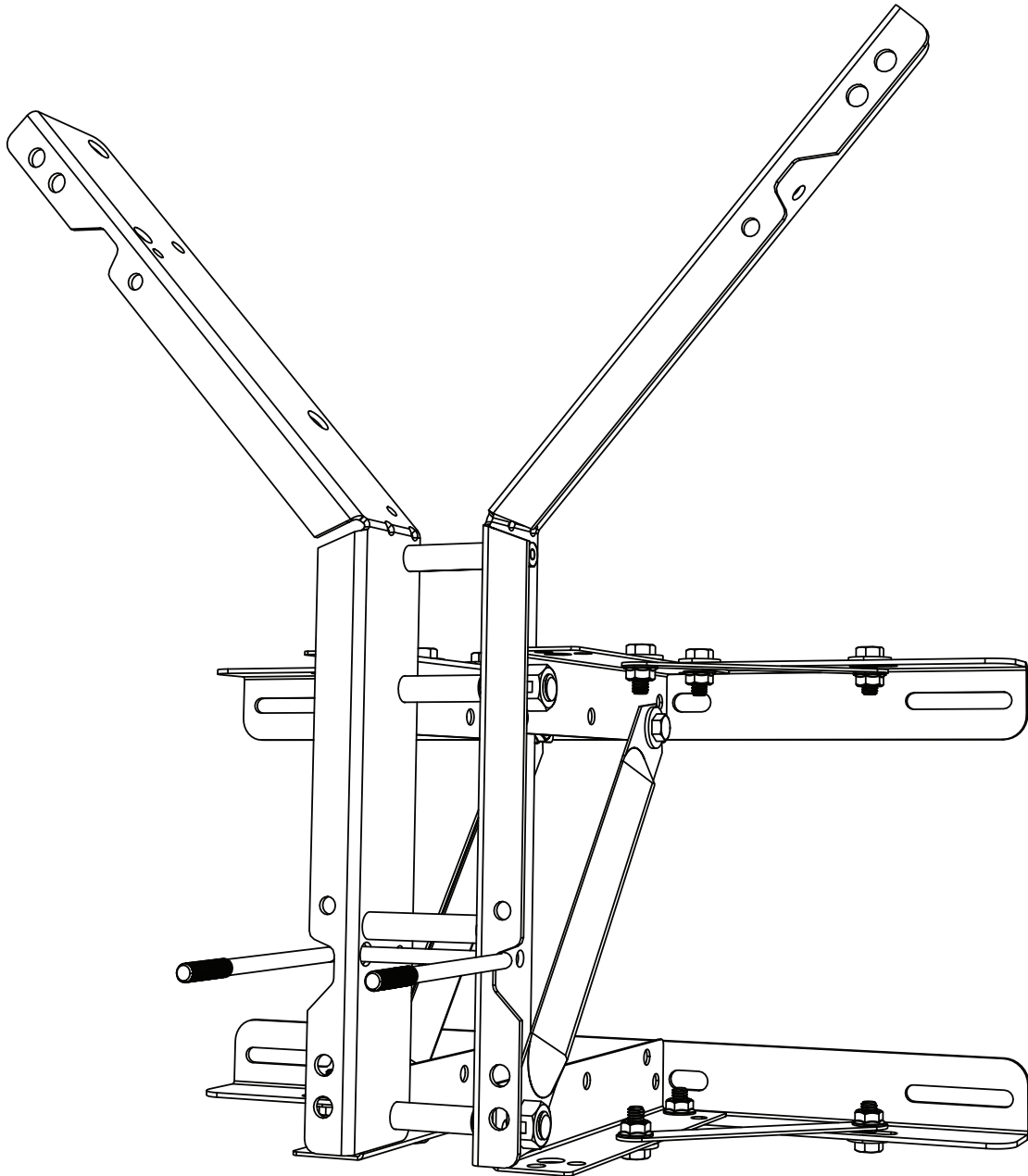



## HARDWARE REQUIRED

## KIT 9594 HARDWARE

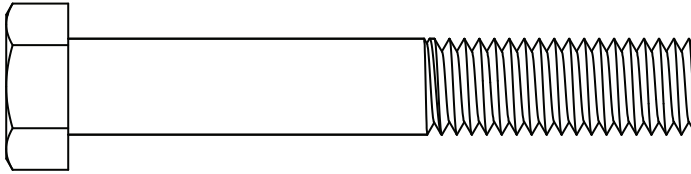

CZY (x2)

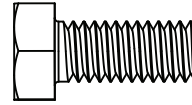

APJ (x14)

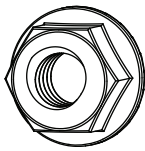

APN (x14)

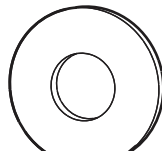

ABD (x14)

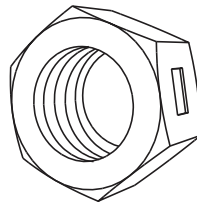

AAX (x2)



## PARTS REQUIRED

## KIT 9594 METAL PARTS

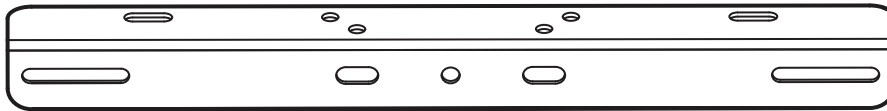

ESG (x2)



ESJ (x4)

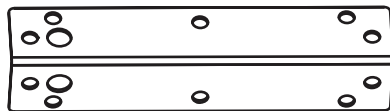

ESH (x4)

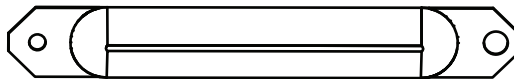

ESI (x2)



## TOOLS REQUIRED

1/2" (≈13 mm)  
(x2)3/4" (≈19 mm)  
(x2)

(x1)



(x3)



(x1)



(x3)

## SECTION 6 (CONTINUED)

### TOOLS AND HARDWARE REQUIRED



(x2)



(x2)



(x1)



## 6.1



- Locate and mark two adjacent studs in the wall where you would like the backboard to hang. **For the rim to be at regulation height, draw a horizontal line 115 5/8" (293,68 cm) from the ground.** Measure up 8" (20,32 cm) from the 115 5/8" (293,68 cm) line and draw another horizontal line parallel to the first. Align the bottom of a **stud bracket (ESG)** with the lower horizontal line, **ensuring the long slots in the bracket align with the studs in the wall.** Secure the bracket to the wall by inserting bolts or lag screws (not included) appropriate for the wall through the long slots in the bracket. Secure the other stud bracket to the studs in the wall, ensuring that the edge of the bracket aligns with the upper horizontal line and that the long slots in the two brackets are aligned.

**Note:** the standard distance between studs is 16" apart on-center.

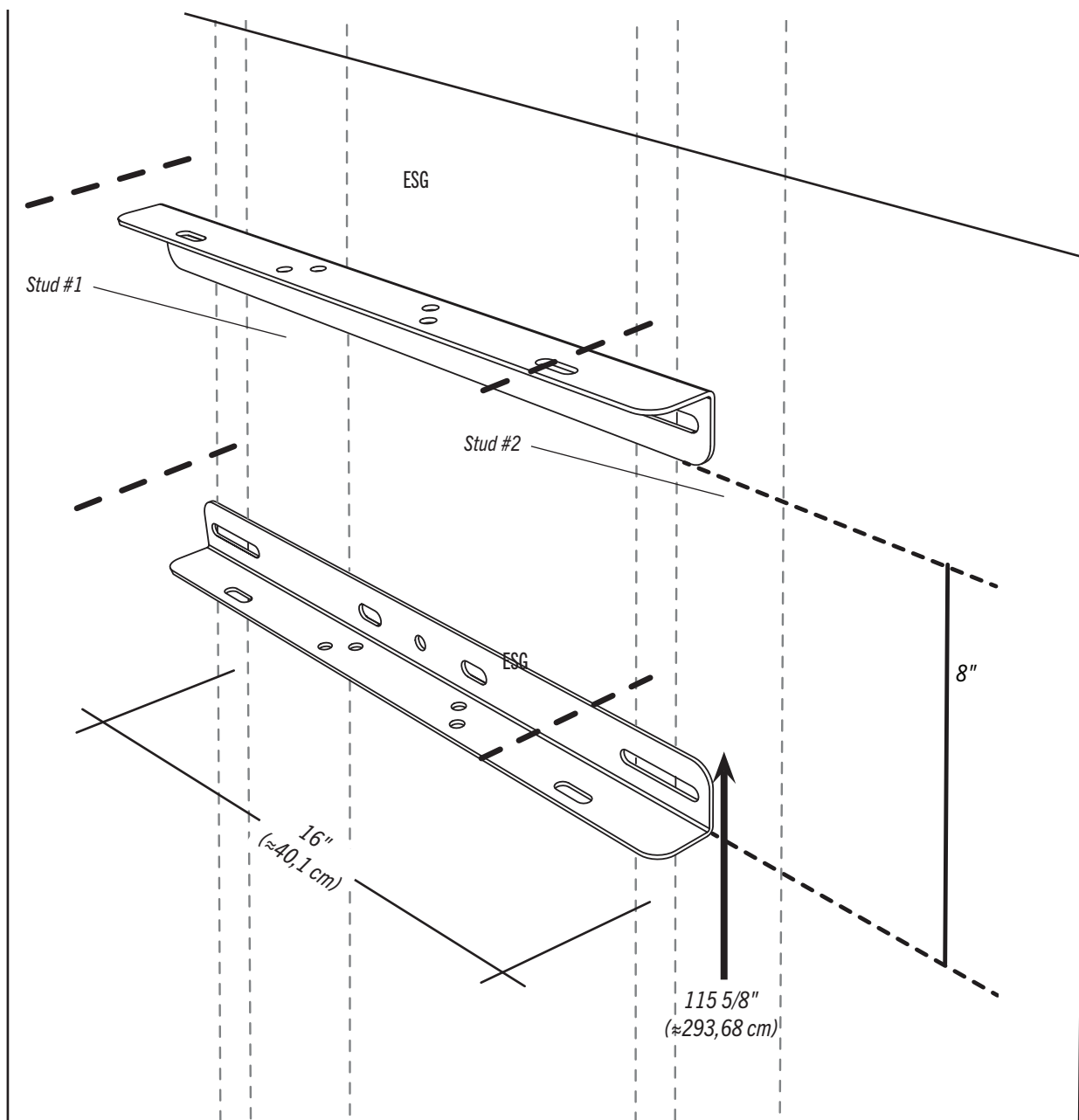

## ► SECTION 6 (CONTINUED)

### TOOLS AND HARDWARE REQUIRED



1/2" (≈13 mm)  
(x2)



(x2)



(x2)

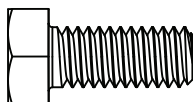

APJ (x4)

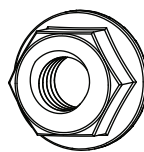

APN (x4)

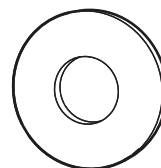

ABD (x4)

## 6.2

- Place the four (4) **extension brackets (ESH)** to the **stud brackets (ESG)** and align the holes indicated. Secure the ends of the extension brackets to the stud brackets. **Ensure you attach the correct end of the brackets as indicated.**

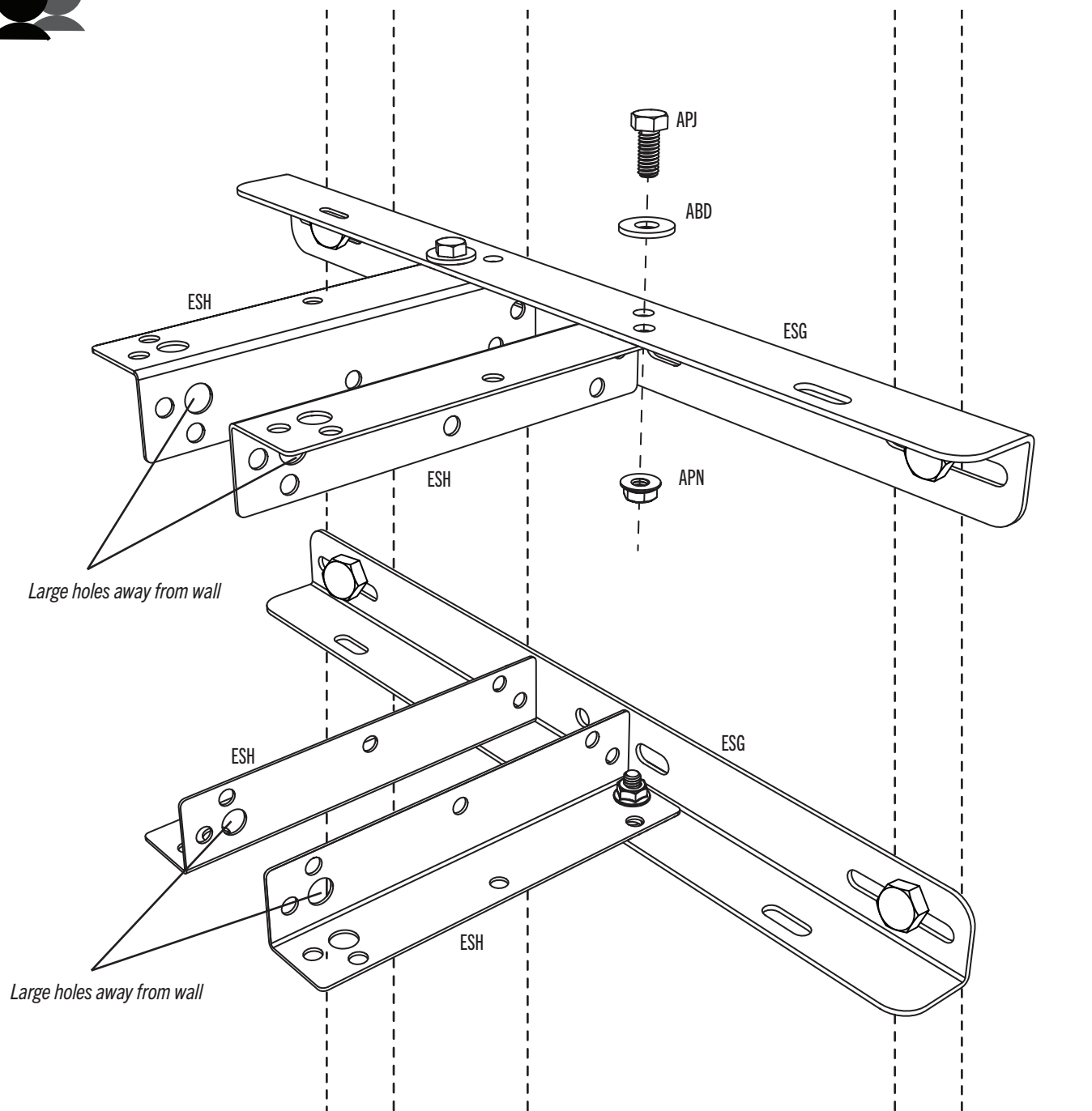

## ► SECTION 6 (CONTINUED)

### TOOLS AND HARDWARE REQUIRED



1/2" (≈13 mm)  
(x2)



(x1)



(x1)

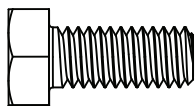

APJ (x12)

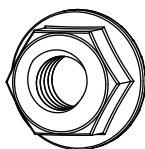

APN (x12)

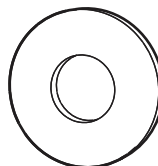

ABD (x12)

## 6.3

- Attach both **diagonal supports (ESI)** to the upper extension brackets with **hex bolts (APJ)**, **flat washers (ABD)** and **flange nuts (APN)**.

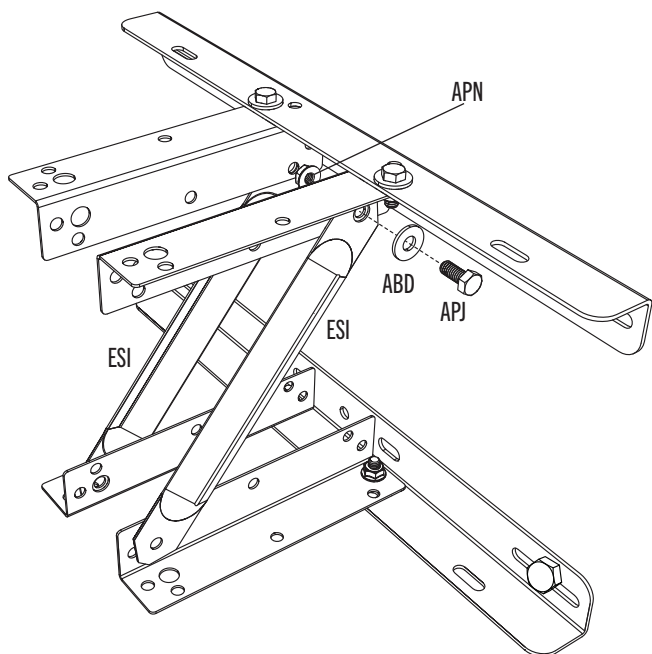

*For clarity, wall and studs not shown*

## 6.4

- Attach the four **stabilizers (ESJ)** to the extension brackets and stud brackets. Use a **hex bolt (APJ)**, a **flat washer (ABD)** and a **flange nut (APN)** for each end of the stabilizers.

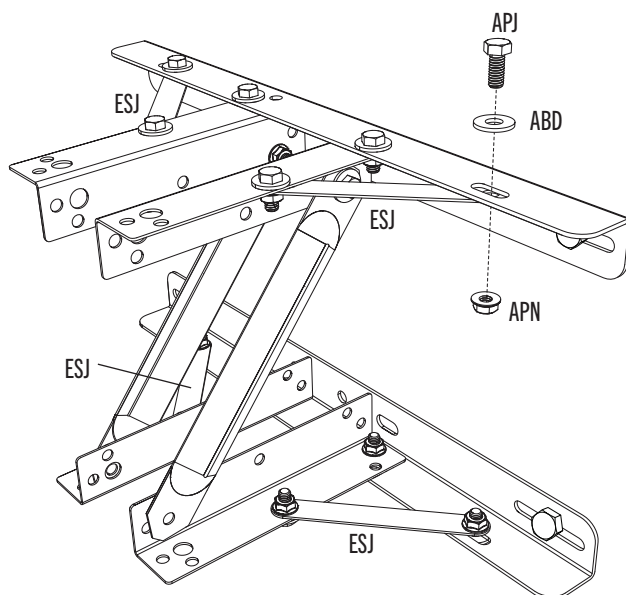

*For clarity, wall and studs not shown*



## SECTION 6 (CONTINUED)

### TOOLS AND HARDWARE REQUIRED



3/4" (≈19 mm)  
(x2)



(x3)



(x3)

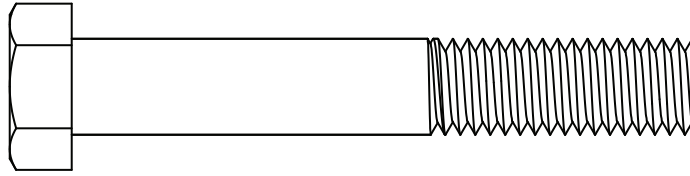

CZY (x2)

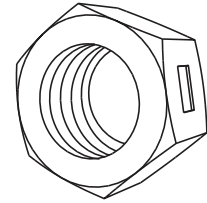

AAX (x2)

## 6.5

### THREE PEOPLE ARE NECESSARY FOR THIS STEP



In this example, we're mounting a Fusion™ backboard & rim combo to a wall; however, all backboard & rim combos mount to a wall in the same way.

- Carefully lift the backboard up to the extension brackets on the wall-mounted kit. Align the holes in the upper extension brackets with those in the backboard brackets with a **hex bolt (CZY)** and **centerlock nut (AAX)**. Align the lower holes in the backboard brackets with those in the diagonal supports and the lower extension brackets. Secure the diagonal with another **hex bolt (CZY)** and **centerlock nut (AAX)**.

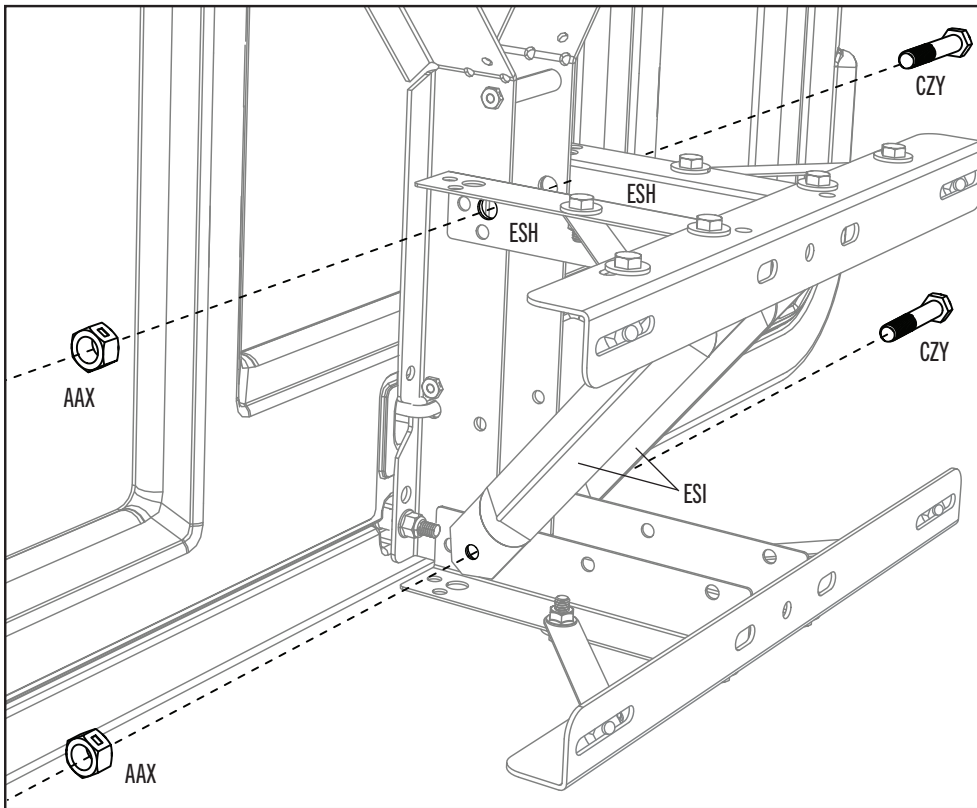

In this step we attached a Fusion™ backboard, but the step still applies for Impact™ and metal-framed backboards.

Wall and studs are not shown for clarity

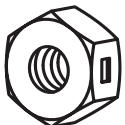

- These nuts are centerlock nuts. They are designed to be tight; therefore, they will be harder to tighten. Tighten until flush with the extension brackets.

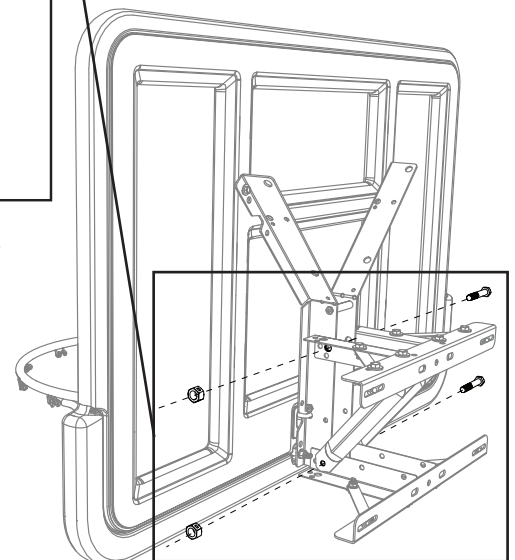

Wall and studs not shown for clarity





## NOTES



## REGISTER YOUR PRODUCT ONLINE AT [WWW.LIFETIME.COM](http://WWW.LIFETIME.COM)

At Lifetime®, we are committed to providing innovative and quality products. While registering, you will have the opportunity to give us your feedback. Your input is valuable to us.

- You can also opt in to receive new product notifications or promotions.
- In the unlikely event of a product recall or safety modification, your registration provides the information we need to notify you directly.
- Registration is fast, easy, and completely voluntary.

### **LIFETIME'S PROMISE TO YOU:**

*Maintaining your privacy is our long-standing policy at Lifetime®. And you can rest assured that Lifetime® will not sell or provide your personal data to other third parties, or allow them to use your personal data for their own purposes.*

We invite you to read our privacy policy at [www.lifetime.com](http://www.lifetime.com)

**REGISTER today!**



## 5-YEAR LIMITED FACTORY WARRANTY

**THE MANUFACTURER RESERVES THE RIGHT TO MAKE SUBSTITUTIONS TO WARRANTY CLAIMS IF PARTS ARE UNAVAILABLE OR OBSOLETE.**

1. Lifetime basketball systems are warranted to the original purchaser to be free from defects in material or workmanship for a period of five years (60 months) from the date of original retail purchase. The word "defects" is defined as imperfections that impair the use of the product. Defects resulting from misuse, abuse or negligence will void this warranty. This warranty does not cover defects due to improper installation, alteration or accident. This warranty does not cover damage caused by vandalism, rusting, "acts of nature" or any other event beyond the control of the manufacturer.
2. This warranty is nontransferable and is expressly limited to the repair or replacement of defective product. If the product is defective within the terms of this warranty, Lifetime Products, Inc. will repair or replace defective parts at no cost to the purchaser. Shipping charges to and from the factory or distribution center are not covered and are the responsibility of the purchaser. Labor charges and related expenses for removal, installation or replacement of the product or its components are not covered under this warranty.
3. This warranty does not cover scratching or scuffing of the product that may result from normal usage. In addition, defects resulting from intentional damage, negligence, unreasonable use or hanging from the rim will void this warranty.
4. Liability for incidental or consequential damages is excluded to the extent permitted by law. While every attempt is made to embody the highest degree of safety in all equipment, freedom from injury cannot be guaranteed. The user assumes all risk of injury resulting from the use of this product. All merchandise is sold on this condition, and no representative of the company may waive or change this policy.
5. This product is not intended for institutional or commercial use; Lifetime Products, Inc. does not assume any liability for such use. Institutional or commercial use will void the warranty.
6. Our goods come with guarantees that cannot be excluded under the Australian Consumer Law. You are entitled to a replacement or refund for a major failure and for compensation for any other reasonably foreseeable loss or damage. You are also entitled to have the goods repaired or replaced if the goods fail to be of acceptable quality and the failure does not amount to a major failure.
7. This warranty is expressly in lieu of all other warranties, expressed or implied, including warranties of merchantability or fitness for use to extent permitted by Federal and state law. Neither Lifetime Products, Inc., nor any representative assumes any other liability in connection with this product. This warranty gives you specific legal rights, and you may also have other rights which vary from state to state.

**PLEASE INCLUDE YOUR DATED SALES RECEIPT AND PHOTOGRAPHS OF DAMAGED PARTS.**

**REPORT PRODUCT DEFECTS IN WRITING TO:**

Lifetime Products, Inc., PO Box 160010 Clearfield, UT 84016-0010  
or dial 1-800-225-3865 M-F 7 a.m. to 5 p.m. MST.

**REGISTER YOUR PRODUCT FOR QUICKER CUSTOMER SERVICE.**

Visit [www.lifetime.com](http://www.lifetime.com) or dial 1-800-225-3865 to register your product today.

**FOR INTERNATIONAL WARRANTY CLAIMS:**

All warranty claims must be accompanied by a sales receipt. Report all warranty claims in writing to your regional sales support representative. Please include your dated sales receipt and photographs of damaged parts.  
To Identify the representative for your region, please visit: [www.lifetime.com/international](http://www.lifetime.com/international)



[www.lifetime.com](http://www.lifetime.com)

**ENHANCE YOUR LIFETIME® PURCHASE BY ADDING ACCESSORIES OR OTHER GREAT PRODUCTS**

*To purchase accessories or other Lifetime® products, visit us at:*

***www.lifetime.com***

*Or call: 1-800-424-3865*

7:00 am–5:00 pm (M–F) MST and 9:00 am–1:00 pm Saturday MST



**www.lifetime.com**

