



Double Bunks

Manufactured by Bob Barker Company, Inc.

Revised 09/01/03

The BarkerBuilt® Advantage

Practical design, heavy-duty construction and premium powder coat finishing. BarkerBuilt's triple-feature profile provides exactly what you're looking for - a full line of quality metal furnishings that will give years of high-performance, low maintenance service in abuse-prone correctional and detention settings.

Materials

All materials are new and free from imperfections that may adversely affect appearance or durability. All sheet steel is cold-rolled, pickled and oiled furniture grade.

Construction

One-piece, 10-gauge formed steel pans. Prepunched bolt holes for optional add-ons also provide ventilation and drainage. 10-gauge formed steel legs. Each leg has one floor-mounting tab with one 5/8" anchor hole at the bottom. Legs are shipped detached for easy bolt-on field assembly. Bolts, lock-washers and nuts are provided. Legs can be field-welded if desired.

Welding

Exposed welds are ground smooth in non-critical areas. Unexposed welds do not require finish grinding, but have good uniform appearance. All welds are thoroughly fused and sound.

Finish

Gray full finish powder coat, for excellent resistance to corrosion, heat, impact, abrasion and fading. Automatic three stage cleaning and pretreatment with in-line oven drying and electrostatic application of powder provides a fully finished 3 MIL. (avg.) coating weight of 60-70 gloss or textured surfaces. No need for additional painting after installation.

Standard Options

Ladders, Lockable Under-Bunk Storage Drawers, Open Under-Bunk Storage Shelves and Safety Sleep Rails. Security Bolt and Expansion Wedge Anchor Kits.

Fabrication Options

Custom designs, materials, sizes, colors and finishes.

Warranty

Bob Barker Company, Inc. warrants our detention furnishings to be free of any defects in materials or workmanship for one (1) year from the date of project completion. Our liability is strictly limited to the repair or replacement of units that in our opinion are found defective. This warranty is in lieu of all other warranties, expressed or implied.

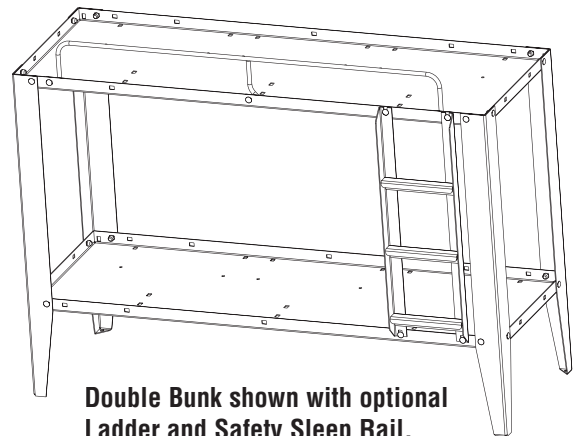

Double Bunk shown with optional Ladder and Safety Sleep Rail.



Bob Barker Company, Inc.

1-800-334-9880 ph. • 1-800-322-7537 fax

www.barkerbuilt.com



Double Bunks

Manufactured by Bob Barker Company, Inc.

Bob Barker Company, Inc. reserves the right to make engineering changes or other modifications at our discretion without notice.

Revised 09/01/03

One-piece, 10-gauge formed steel pans. Prepunched bolt holes for optional add-ons also provide ventilation and drainage.

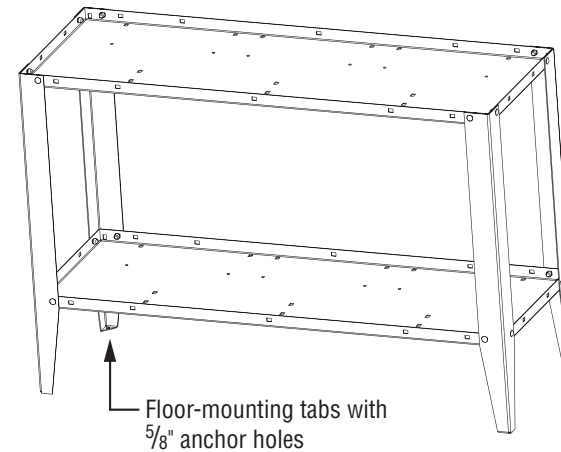
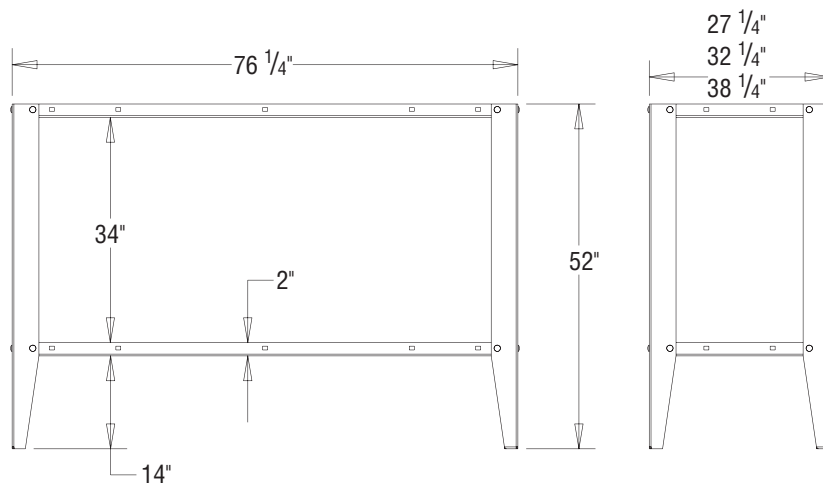
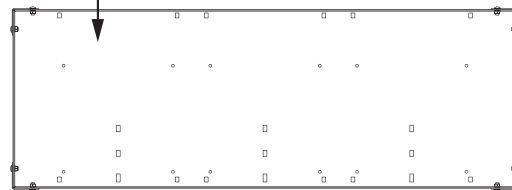

Floor-mounting tabs with 5/8" anchor holes



Double bunks should be securely anchored to the floor. Each bunk requires 4 anchors for floor attachment.

Standard Options

Ladders, Lockable Under-Bunk Storage Drawers, Open Under-Bunk Storage Shelves and Safety Sleep Rails. Security Bolt and Expansion Wedge Anchor Kits.

Fabrication Options

Custom designs, materials, sizes, colors and finishes.

| Item # | Actual Sleeping Surface | Weight |
|--------|-------------------------|----------|
| DB1 | 27" W x 76" L | 259 LBS. |
| DB32 | 32" W x 76" L | 283 LBS. |
| DB38 | 38" W x 76" L | 308 LBS. |

You will need: **(1) Ratchet with ½" socket (not included)**

(2) Bed Pans

(4) Legs

Hardware kit containing

(16) ½-13 X 1 CARRIAGE BOLT



(16) ½-13 HEX NUT



(16) ½" LOCK WASHER



Note: This unit must be assembled by two or more people working together. Failure to do so may cause physical injury.

Assembly Instructions – please read all instructions before beginning:

Step 1 Lay two legs on the floor, parallel to each other at approximately the length of a bed pan.

Step 2 To install the lower bunk - Stand up one of the bed pans on edge lengthwise, with the formed edges facing the top of the leg. Line up the bed pan holes with the lower holes in the legs. *Do not line up with the top of the legs.*

Step 3 With one person holding the bed pan on edge, insert carriage bolts from the outside of the leg through the leg and bed pan – 2 on each leg. Apply a lock washer and hex nut to each carriage bolt and *tighten fully with a ratchet*. When all four carriage bolts are installed and hex nuts tightened, the bed pan should be able to stand on its own.

Step 4 To install the upper bunk – Repeat steps two and three, lining up with the holes in the top of the leg this time. Install the bolts, washers, and nuts as before – *tighten fully*. The top bed pan should stand on its own.

Step 5 Apply the remaining two legs to the top of the bed pans in the same direction as the first and Install the bolts, washers, and nuts as before – *tighten fully*. The bed should now be fully assembled.

Step 6 Using at least two people, stand up the double bunk so the bottoms of the legs are fully on the floor. Retighten all hardware. Bolt the double bunk bed to the floor using strong anchor bolts (not provided).

